



Heath Court, Heath Road, BAGSHOT, Surrey GU19 5LH

PRICE £200,000 Share of Freehold

*****OFFERED FOR SALE WITH NO ONWARD CHAIN AND A SHARE OF FREEHOLD***** Jigsaw Estates are pleased to present to the market this perfect ground floor starter home situated in a quiet tucked away position within the popular village of Bagshot.

Accommodation comprises a double bedroom with built in storage cupboards, generous living room and separate kitchen. There is also a bathroom, further fitted storage and electric storage heaters. The biggest unique feature is the private rear garden which is low maintenance and currently shingled with a patio area. To the front of the property there is a large communal car park offering parking for you as well as visitors.

The property is only a stones throw from Bagshot village centre which offers a range of pubs, cafes and local shops including a Co-op supermarket. There is the large Waitrose Supermarket located just off the A30 and for people looking to commute the train station and Junction 3 of the M3 are both within easy reach.



- NO ONWARD CHAIN
- NO CHARGES
- PRIVATE REAR GARDEN
- EXCELLENT TRANSPORT LINKS
- AMPLE PARKING

- SHARE OF FREEHOLD
- ONE BEDROOM GROUND FLOOR
- VILLAGE LOCATION
- DOUBLE BEDROOM WITH BUILT IN WARDROBES

Ground Floor

Approx. 41.0 sq. metres (441.8 sq. feet)

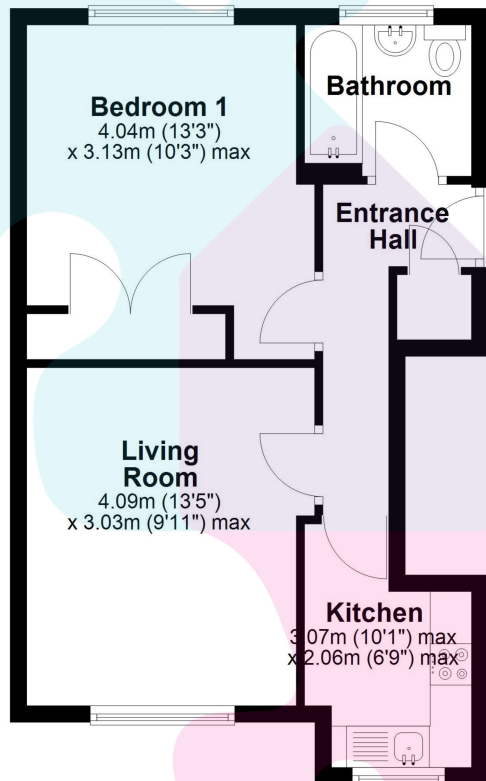

Total area: approx. 41.0 sq. metres (441.8 sq. feet)

Floorplan is for illustration purposes only. All measurements are approximate and should be verified. Total Floor Area includes any garages, outhouses or ancillary buildings shown on the floorplan.
EPC and Floorplan produced by WWW.G-Whis.net
Plan produced using PlanUp.

Energy Efficiency Rating		
	Current	Potential
Very energy efficient - lower running costs		
(92+) A		
(81-91) B		
(69-80) C		
(55-68) D	65	70
(39-54) E		
(21-38) F		
(1-20) G		
Not energy efficient - higher running costs		
England, Scotland & Wales		EU Directive 2002/91/EC

