



KUBIE GOLD
ASSOCIATES

WATERDALE MANOR HOUSE HAREWOOD AVENUE NW1



- THREE BED TWO BATHROOMS
- PORTERED BLOCK
- SECOND FLOOR WITH LIFT

- LARGE & SPACIOUS APARTMENT
- WOOD FLOOR THROUGHOUT
- AVAILABLE 18TH AUGUST

£923 per week

SALES, LETTINGS & PROPERTY MANAGEMENT

Tel:

020 7563 7272

36 Ivor, Regents Park, London, NW1 6EA

Email: info@kubie-gold.co.uk Website: www.kubie-gold.co.uk

Kubie Gold Associates is the trading name of Kubie Gold Associates Ltd
Company Registration No. 7271501 registered in England and Wales



Waterdale Manor House , NW1

Recently refurbished three bedroom two bathroom apartment in popular portered building, good size reception, large bedrooms with fitted wardrobes giving ample storage, separate fully fitted kitchen, full family bathroom and Further ensuite, property benefits from wood floors throughout & 24 hour porters, set on the second floor with a lift, sharers accepted (HMO license in place) situated very near to both Marylebone & Baker Street Tube Stations and all amenities of Marylebone, immediate viewing highly recommended. Virtual tour available 18th August.

Waterdale Manor House Approx. Gross Internal Area 1046 Sq Ft - 97.18 Sq M

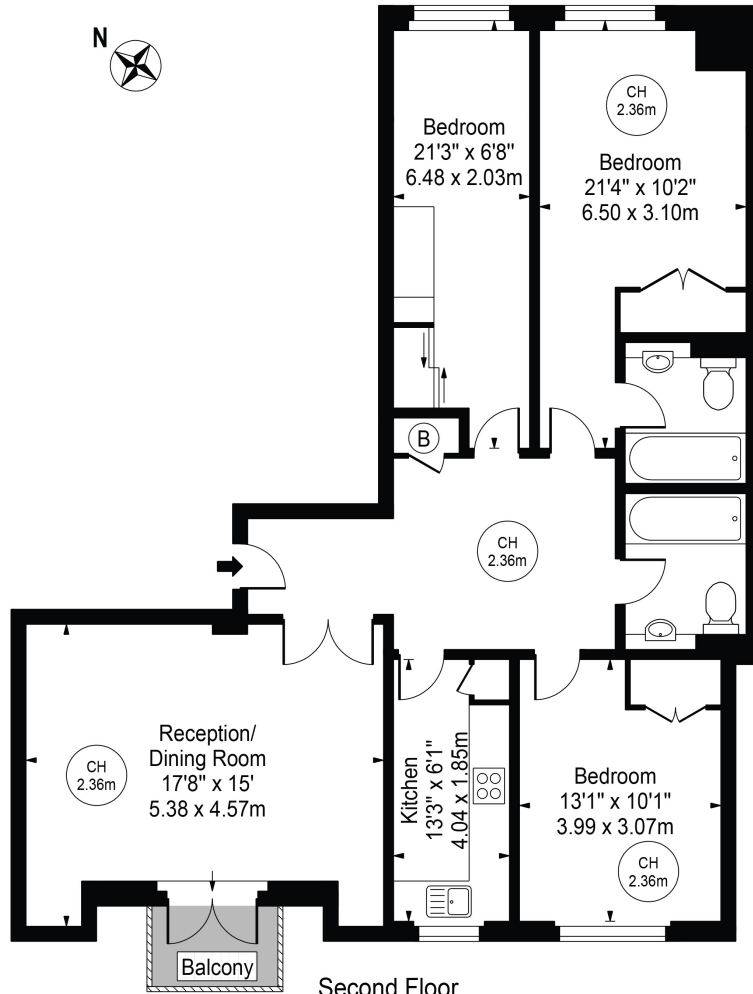

Second Floor

For Illustration Purposes Only - Not To Scale

This floor plan should be used as a general outline for guidance only and does not constitute in whole or in part an offer or contract. Any intending purchaser or lessee should satisfy themselves by inspection, searches, enquiries and full survey as to the correctness of each statement. Any areas, measurements or distances quoted are approximate and should not be used to value a property or be the basis of any sale or let.

Local Authority:

Westminster

Tax Band:

Band G

Energy Efficiency Rating		Current	Potential
Very energy efficient - lower running costs			
(92-109)	A		
(81-91)	B		
(69-80)	C		
(55-68)	D		
(39-54)	E		
(21-38)	F		
(1-20)	G		
Not energy efficient - higher running costs			
		82	83
England, Scotland & Wales		EU Directive 2002/91/EC	

