



**Ashchurch**

**01684 293246**



## 40 Fitzhamon Park, Ashchurch, Tewkesbury, GL20 8JL

This is a great house located on the edge of Tewkesbury in a small residential area, Fitzhamon Park.

At the front of the property there is parking for several cars and a long garden lawn and path lead to the front door. To the side is gated side access to the rear garden.

Inside the accommodation is beautifully light, with the entrance hall offering space for coats. The lounge/dining room has a wood effect laminate floor and leads through a doorway into the modern kitchen at the rear.

The kitchen is fitted with a range of wall and base units with an integrated gas hob and electric oven.

A door from the kitchen leads out to the beautiful, private rear garden which has been landscaped with patio area, shed and lawn.

On the first floor there are 2 bedrooms and the bathroom. The main bedroom has the benefit of fitted wardrobes and a cupboard over the stairs.



The modern bathroom comprises of a panel bath with shower over, vanity unit with inset wash basin and low level wc.

The property has the benefit of gas central heating and upvc double glazing.

Fitzhamon Park is small and established residential area of Ashchurch opposite the Parish Church and adjacent to the local primary school, located with ½ mile of the new Dobbies store and soon to be opened Designer Outlet village, and a mile of Ashchurch train station and the motorway network, it is an excellent commuter base.

Tewkesbury itself is less than 3 miles away and offers an excellent range of shops, eateries, sports facilities, schools, entertainment and medical facilities.

### Ground Floor

Living room 16'7"x11'8" max  
Kitchen 11'8"x7'9"

### First Floor

Bedroom 1 12'x8'7"  
Bedroom 2 11'7"x6'7"  
Bathroom 8'5"x4'11"

### Outside

Garden Shed

**Tewkesbury Borough Council Tax Band B**

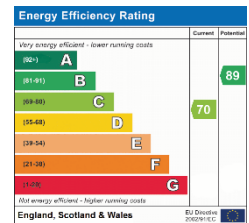
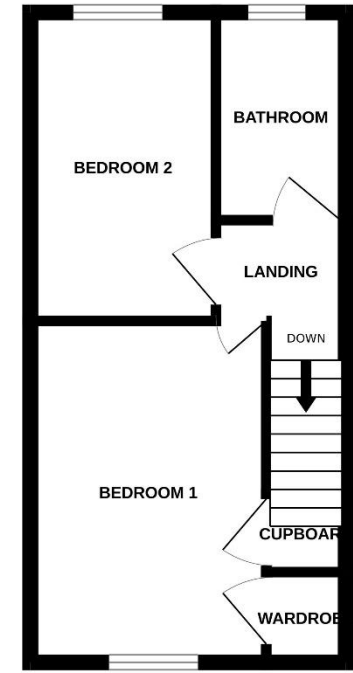
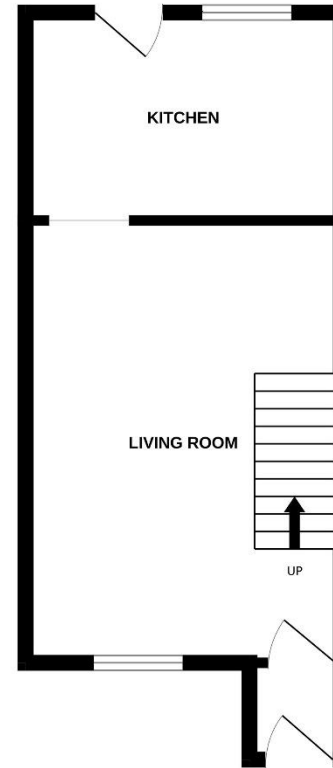

**Guide Price £225,000 Freehold**

Viewing strictly by arrangement with Engall Castle Ltd  
155 High Street Tewkesbury Gloucestershire GL20 5JP  
Office hours: Mon – Fri 9am to 6pm, Sat 9am to 4pm  
email: [sales@engallcastle.com](mailto:sales@engallcastle.com)

**01684 293 246**  
[www.engallcastle.com](http://www.engallcastle.com)



This floorplan is provided for guidance only as an approximate layout of the property and should not be relied upon as a statement of fact.

### Agents Note

These property details are set out as a general outline only and do not constitute any part of an Offer or Contract. Any services equipment, fittings or central heating systems have not been tested and no warranty is given or implied by Engall Castle Ltd that these are in working order. Buyers are advised to obtain verification from their solicitor or surveyor. Fixtures and fittings or other items are not included unless specifically described. All measurements, distances and areas are approximate and for guidance only and should not be relied upon for the purposes of fitting carpets or furniture etc. These property details and all statements within this document are provided without responsibility on behalf of Engall Castle Ltd or its employees or representatives and should not be relied on as statements of fact. Prospective purchasers must satisfy themselves as to the accuracy of all details pertaining to the property.

