



268 Hitchin Road, Henlow Camp, Henlow, Bedfordshire, SG16 6DP

£155,000

GREAT RENTAL INVESTMENT. Fully refurbished GROUND FLOOR apartment situated in the heart of Henlow Camp - walking distance to all the local amenities. Offering open plan accommodation with bright spacious living room plus BRAND NEW fully fitted Wren kitchen with built in appliances including, oven, hob, extractor hood, washer/dryer and fridge/freezer. Large bedroom with wardrobes and adjoining shower cubicle and wash basin + separate toilet. LONG LEASE approx 950 years, no ground rent, well-presented. KEY FOR VIEWING.

Lane &
BENNETTS

268 Hitchin Road

Approximate Gross Internal Area
463 sq ft - 43 sq m

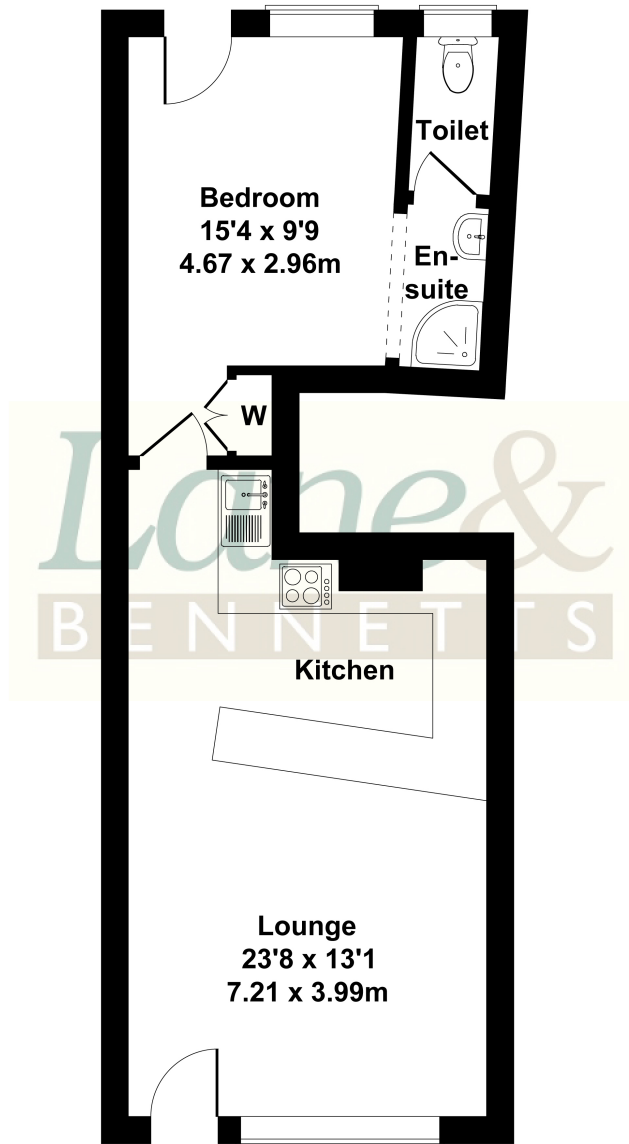

Not to Scale. Produced by The Plan Portal 2025
For Illustrative Purposes Only.

- GREAT RENTAL INVESTMENT- CASH BUYER ONLY
- GROUND FLOOR APARTMENT
- OPEN PLAN LIVING ROOM WITH NEW WREN FITTED KITCHEN
- NEW BUILT IN APPLIANCES INCLUDING HOB + OVEN + WASHER DRYER + FRIDGE FREEZER
- LARGE DOUBLE BEDROOM WITH WARDROBES
- NEW SHOWER CUBICLE + SEPARATE TOILET
- OFF ROAD PARKING
- ALL LOCAL AMENITIES ON YOUR DOORSTEP
- EASY ACCESS TO HITCHIN + LOCAL TRAIN STATION
- TAX BAND A / EPC BAND E

