

115 Harbour Way

Folkestone
CT20 1NA

£280,000 FREEHOLD

FOR SALE WITH BURNAP + ABEL... Burnap + Abel are delighted to offer this four bedroom mid terraced house situated close to Folkestone Harbour and The Harbour Arm. The property has been recently refurbished throughout and the accommodation comprises lounge/diner, kitchen, family bathroom and four bedrooms. Additional benefits include a private rear garden, double glazing, gas central heating and no onward chain. For your chance to view call sole agent Burnap + Abel now on 01303 258590.



Entrance Porch

Lounge/Diner

24' 11" x 13' 0" (7.59m x 3.96m)

Kitchen

13' 10" x 7' 7" (4.22m x 2.31m)

Bathroom

13' 10" x 4' 11" (4.22m x 1.50m)

First Floor Landing

Bedroom One

13' 2" x 10' 6" (4.01m x 3.20m)

Bedroom Two

10' 7" x 8' 9" (3.23m x 2.67m)

Bedroom Three

12' 10" x 8' 4" (3.91m x 2.54m)

Bedroom Four

12' 10" x 8' 9" (3.91m x 2.67m)

Rear Garden

Ground Floor
Approx. 47.1 sq. metres (506.7 sq. feet)

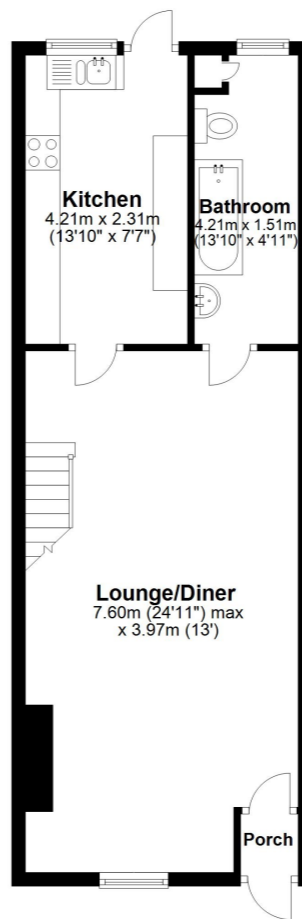

First Floor
Approx. 29.1 sq. metres (313.1 sq. feet)

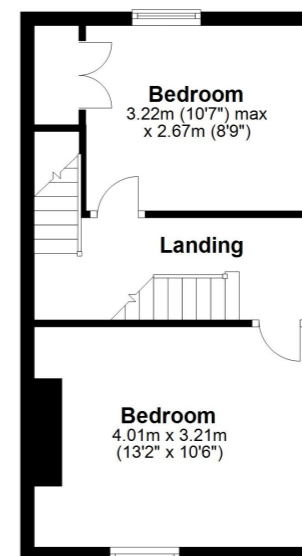

Second Floor
Approx. 24.0 sq. metres (258.7 sq. feet)

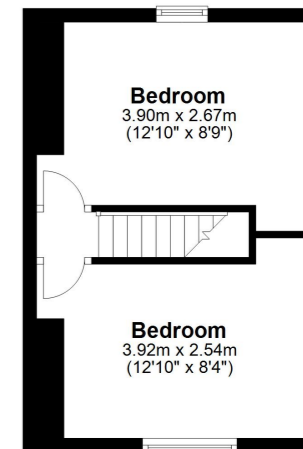

Whilst every attempt has been made to ensure the accuracy of the floor plan contained here, measurements of doors, windows, rooms and any other items are approximate and no responsibility is taken for any error, omission or mis-statement. This plan is for illustrative purposes only and should be used as such by any prospective purchaser.
Plan produced using PlanUp.

