

hastings
INTERNATIONAL



Albany Court

£699,000

Albany Court, London, Spring Grove W4 3BF

A stunning triple aspect penthouse apartment with generous wrap around private terrace, impressive reception room, two bedrooms and two bathrooms, located within a small modern development within the heart of Kew Bridge, moments from the river Thames, the historic Strand-On-The-Green with its selection of riverside pubs, the vast green spaces of Gunnersbury Park and Kew Bridge mainline rail station providing regular rail services to London Waterloo.

This stunning triple aspect penthouse apartment comprises entrance hall with storage cupboard, impressive reception room with dining area, door leads to expansive wrap around private terrace, open plan fitted kitchen with stone work tops and integrated appliances, dual aspect master bedroom with en-suite bathroom, guest bedroom two with fitted wardrobes and door to terrace and family bathroom. There is lift access and a secure allocated parking is available under separate negotiation. Kew Bridge mainline station together with Kew Gardens are a short walk away.

- Albany Court W4
- Penthouse Apartment
- Impressive Wrap Around Terrace
- Two Bathrooms
- Parking Under Separate Negotiation
- 946 Sq Ft
- Triple Aspect
- Two Double Bedrooms
- High Specification Interior
- Excellent Location

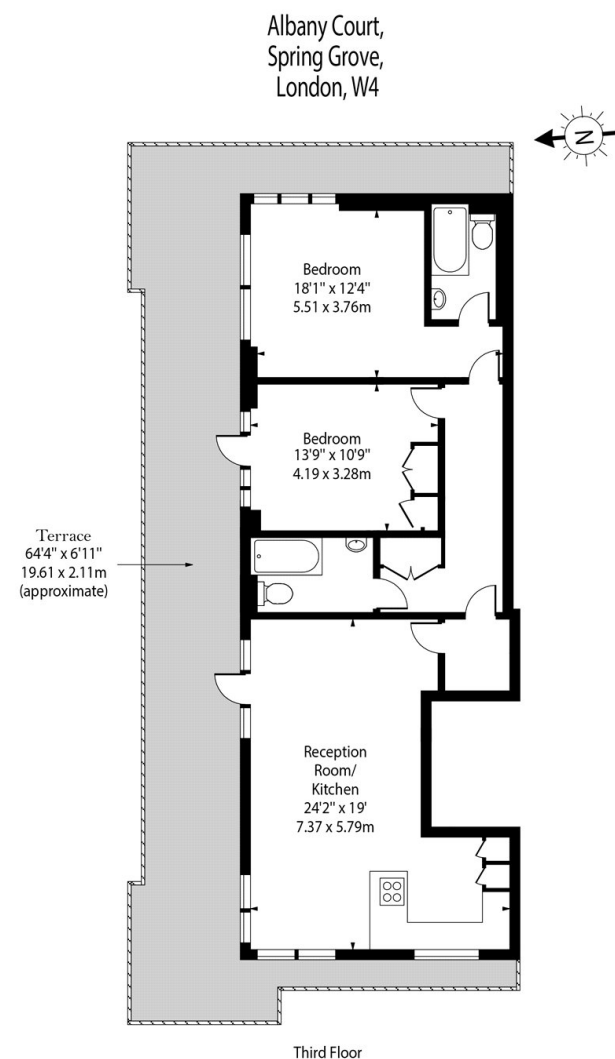

Approx Gross Internal Area 946 Sq Ft - 87.88 Sq M

This floor plan should be used as a general outline for guidance only. Any intending purchaser or lessee should satisfy themselves by inspection, searches, enquiries and full survey as to the correctness of each statement. Any areas, measurements or distances quoted are approximate and should not be used to value a property or be the basis of any sale or let.





Energy Efficiency Rating		
	Current	Potential
Very energy efficient - lower running costs		
(92+) A		
(81-91) B		
(69-80) C	72	72
(55-68) D		
(39-54) E		
(21-38) F		
(1-20) G		
Not energy efficient - higher running costs		
England, Scotland & Wales	EU Directive 2002/91/EC	