



**Willow Drive
Setchey
King's Lynn
Norfolk
PE33 0BG**

Offers in Excess of £305,000

bettermove

**Willow Drive
King's Lynn**

Bettermove are proud to present this 3 bedroom Detached Bungalow in the sought after area of Setchey.

The property benefits from double glazing, gas central heating throughout and has ample off street parking available. The council tax band is B.

The interior of this beautifully presented property comprises a spacious living room with dining area, the fitted kitchen, two bedrooms and the family bathroom on the ground floor. The first floor consists of one double bedroom, office room and the second bathroom. The exterior boasts a private and landscaped rear garden with two outbuildings currently being used as a home gym and bar and games room, perfect for enjoying the summer months.

Located in the popular village of Setchey, the A10 and many local bus routes provide easy access to the town of Kings Lynn and accessible within a 12-15 minute drive. Train links to London Kings Cross are under 2 hours make for easy commuting while Cambridge and Norwich are just over an hour's drive away.

This exciting opportunity should not be missed! All enquiries can be made through Bettermove on 0330 004 0050.

You can secure the purchase immediately by paying an exclusivity deposit of £1,000.

This is not an additional fee and is returned to you on completion.

Paying this deposit ensures that the seller takes the property off the market and reserves it exclusively for you. Therefore, eliminating the risk of being gazumped by another buyer, and incurring aborted costs.

This allows you rights to purchase within a given timeframe (typically 8-12 weeks) which gives you time to prepare funding, surveys, and searches.





GROUND FLOOR
1764 sq.ft. (163.9 sq.m.) approx.

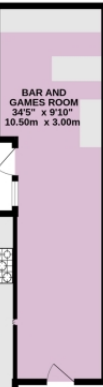
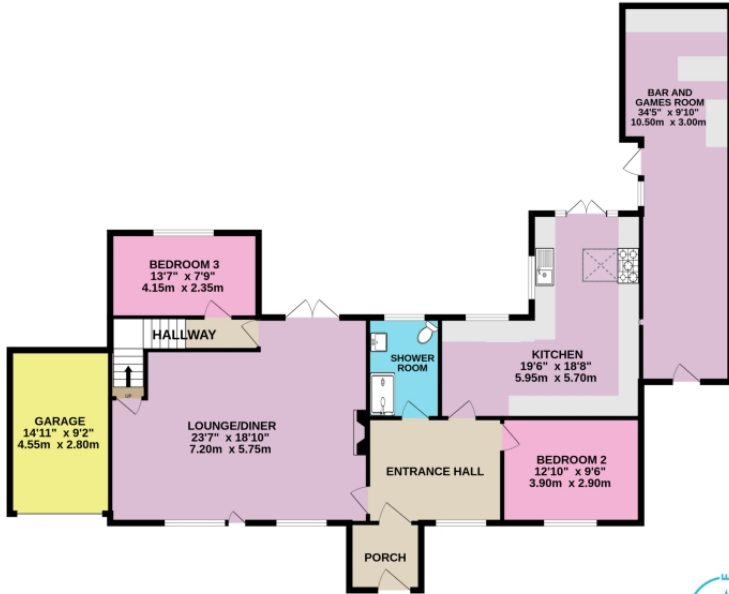

1ST FLOOR
638 sq.ft. (59.3 sq.m.) approx.

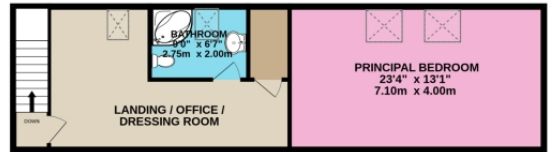

DETACHED 3-BEDROOM CHALET BUNGALOW
TOTAL FLOOR AREA : 2403 sq.ft. (223.2 sq.m.) approx.



20-22 Bridge End, Leeds, LS1 4DJ
t: 0330 004 0050 e: hello@bettermove.co.uk
www.bettermove.co.uk