



Chamberlayne Road, Kensal Rise, NW10

£375,000



## Chamberlayne Road, Kensal Rise, NW10

Situated in the heart of Kensal Rise and located in the highly sought-after City View, is this modern one-bedroom, fourth-floor (with lift) apartment boasting a contemporary interior and stunning views over the north-west London skyline. Additional features include access to an extensive communal roof top with views over the City of London.

This fine flat would make an ideal first-time purchase and further boasts an open-plan kitchen/reception area, a principal bedroom with built-in storage and a stylish bathroom.

City View is perfectly positioned with both Kensal Green station (Bakerloo Line & Overground) and Kensal Rise station (Overground) situated close by, along with Queen's Park station (Bakerloo Line & Overground). Furthermore, local amenities, restaurants and bars can be found just yards away, including Moberly Sports Centre, the Lexi Cinema, Queen's Park and the Grand Union Canal.

### Features

- Stunning Communal Roof Terrace
- One Bedroom
- Fourth Floor (With Lift)
- Perfect Location
- Modern Building
- Contemporary Fully Fitted Kitchen
- Stylish Bathroom
- Bright & Well Presented
- Ideal First Time Purchase





Chamberlayne Road,  
Kensal Rise, NW10

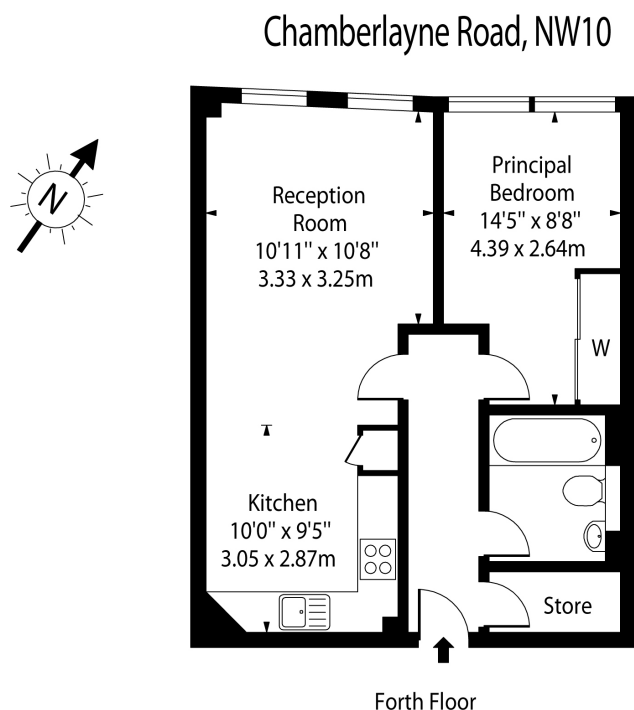

Approx Gross Internal Area      528 Sq Ft - 49.05 Sq M

For Illustration Purposes Only - Not To Scale Floor Plan by [www.nogaphotostudio.com](http://www.nogaphotostudio.com) Ref: No.41178

This floor plan should be used as a general outline for guidance only. Any intending purchaser or lessee should satisfy themselves by inspection, searches, enquiries and full survey as to the correctness of each statement. Any areas, measurements or distances quoted are approximate and should not be used to value a property or be the basis of any sale or let.