



NEWSON & BUCK  
ESTATE AGENTS



## 1 Stebbings Close, Grimston, King's Lynn, Norfolk PE32 1D£299,995

Newson and Buck are delighted to present this three bedroom detached bungalow situated in the popular Village of Grimston. The property is primed ready for you to put your own stamp on and tweak to suit your needs. The accommodation comprises entrance hall, lounge, kitchen, w/c, three bedrooms and bathroom as well as a conservatory. The property further benefits from off road parking, private wrap around garden with storage sheds and a garage externally. The property further benefits from recently installed UPVC double glazed windows as well as oil central heating. Local amenities can be found in the village with more extensive facilities found in King's Lynn Town Centre including a main line rail link into Cambridge and London King's Cross.

6' 06" x 4' 09" (1.98m x 1.45m) Entrance door, window to side, tiled flooring, door to storage cupboard, door leading to

4' 09" x 3' 00" (1.45m x 0.91m) Tiled Floor, window to side, low level flush w/c, hand basin.

20' 08" max x 12' 05" (6.30m max x 3.78m) Laminate flooring, electric fireplace, radiator, window to front, multiple wall lights, doors leading to

11' 11" x 7' 08" (3.63m x 2.34m) Range of base units, pantry cupboard, tiled flooring, tiled walls, sink, door leading to

10' 09" x 10' 01" (3.28m x 3.07m) Tiled flooring, radiator, door leading to rear garden

Storage Cupboard, loft access, doors leading to

11' 04" x 9' 05" (3.45m x 2.87m) Laminate flooring, radiator, window to front, built in wardrobes.

10' 08" x 8' 01" (3.25m x 2.46m) Carpeted, Window to rear, radiator

7' 08" x 6' 05" (2.34m x 1.96m) Carpeted, window to rear, radiator

7' 08" x 6' 05" (2.34m x 1.96m) Tiled walls, low level flush w/c, hand basin, electric shower, vinyl flooring, airing cupboard.



GROUND FLOOR  
913 sq.ft. (84.9 sq.m.) approx.

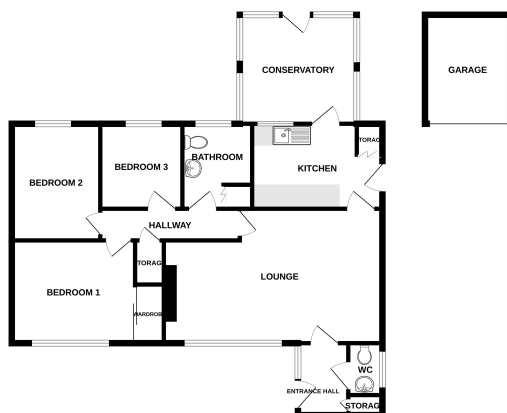

**TOTAL FLOOR AREA: 913 sq ft (84.9 sq m.) approx.**