



THE ESTATE AGENTS
1977



Ilex Close, Hardingstone, Northampton NN4 6DS
Offers Over £150,000 - Leasehold



PROPERTY DESCRIPTION

The Estate Agents are pleased to present this two bedroom maisonette in the highly desirable and sought after village of Hardingstone.

The accommodation briefly comprises; entrance porch with stairs leading to a spacious landing, large living room, two generous bedrooms, kitchen and bathroom. Outside the property benefits from a rear garden, garage and communal off road parking. The current owner has extended the lease to 133 years and there's no ground rent or service charges to pay.

Hardingstone is a village which has a post office, convenience store two pubs and sits within easy reach of the town centre, train station and Delapre Abbey. The property benefits from great road links with the A45 and M1.

Note: Some of the photos have been virtually staged.

POINTS OF INTEREST

- Two Bedroom Maisonette
- Highly Desirable & Sought After Village
- First Floor
- Large Living Room
- Views From Both Bedrooms
- Garage
- Communal Off Road Parking
- Lease Already Extended To 133 Years
- No Ground Rent Or Service Charges
- No Upward Chain

FIRST FLOOR
607 sq.ft. (56.4 sq.m.) approx.

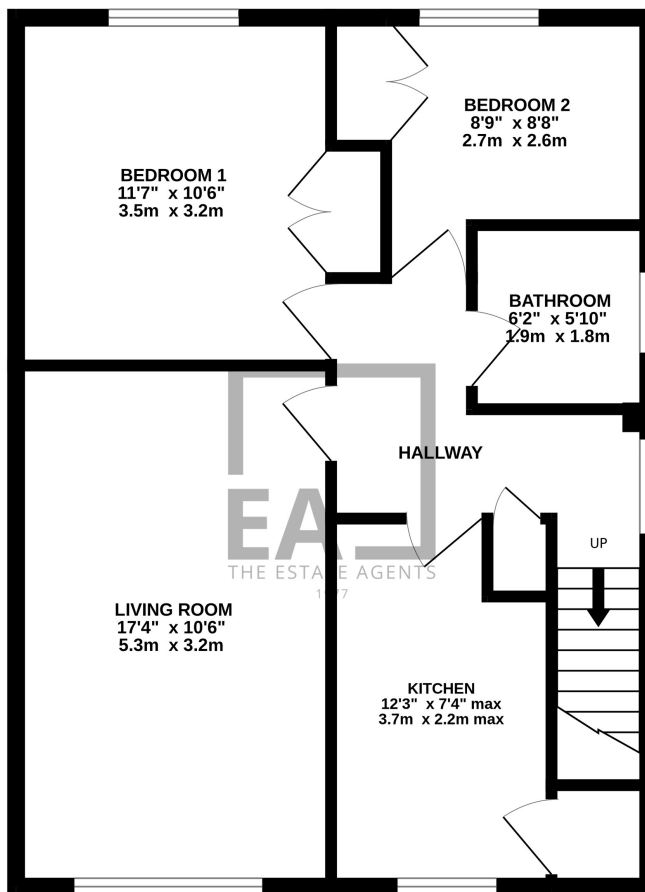

TOTAL FLOOR AREA : 607 sq.ft. (56.4 sq.m.) approx.

Whilst every attempt has been made to ensure the accuracy of the floorplan contained here, measurements of doors, windows, rooms and any other items are approximate and no responsibility is taken for any error, omission or mis-statement. This plan is for illustrative purposes only and should be used as such by any prospective purchaser. The services, systems and appliances shown have not been tested and no guarantee as to their operability or efficiency can be given.
Made with Metropix ©2026