



KANE COURT, PEARTREE WAY, GREENWICH, LONDON SE10 0JR

£575,000

Stunning two bedroom apartment situated in Kane Court in the immensely popular Greenwich Millennium Village development, North Greenwich. This bright, airy and very spacious two bedroom, two bathroom apartment is offered in fantastic condition. Accommodation boasts over 900 sq. ft. of internal floor space and comprises of a spacious lounge with a sleek and stylish open plan kitchen, two double bedrooms, enuite and modern bathroom.

Further benefits include a large sunny balcony and concierge services. The development is located minutes from North Greenwich tube station (Jubilee Line), the Emirates Cable Cars and the O2 with the many attractions within, including bars and restaurants and shops. Other notable amenities within walking distance include, schools, the river bus, local retail park and supermarkets.

VIEWING BY APPOINTMENT WITH 1ST AVENUE. CALL: 020 8293 8600

**9 KANE COURT,
PEARTREE WAY,
GREENWICH, LONDON
SE10 0JR**

£575,000

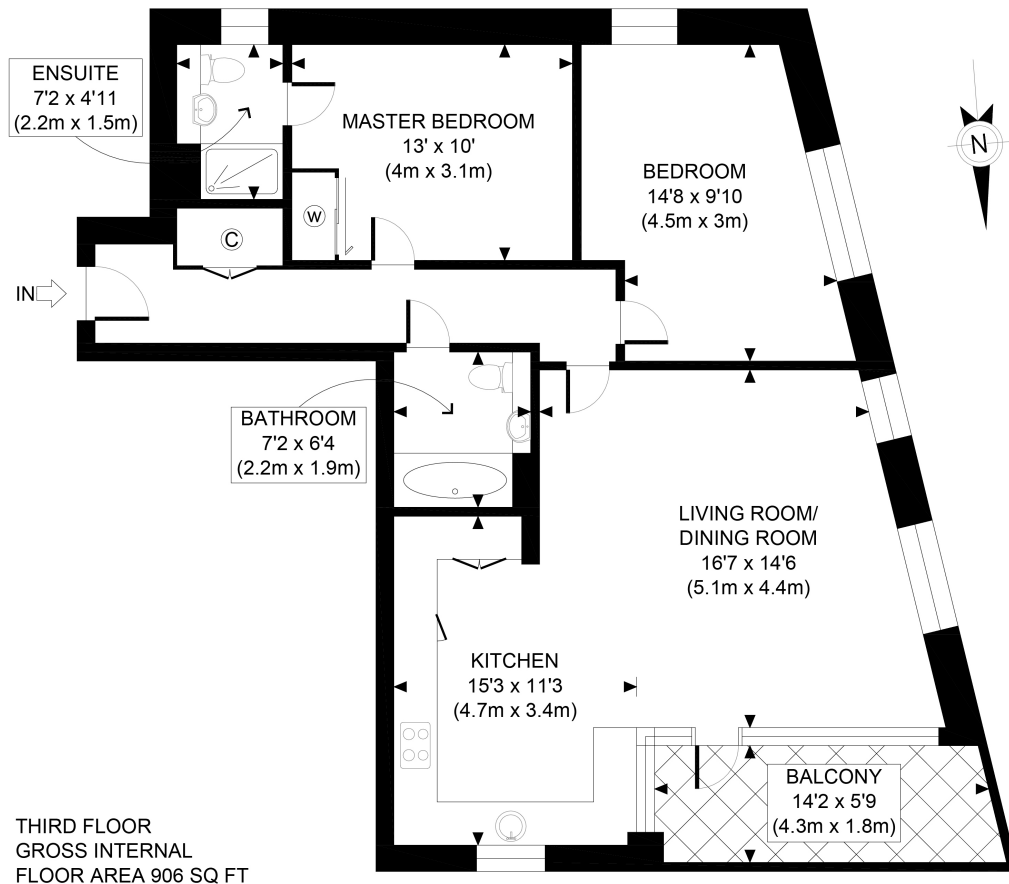

APPROX. GROSS INTERNAL FLOOR AREA 906 SQ FT / 84 SQM

Ref:

Copyright **photoplan**

Disclaimer: Floor plan measurements are approximate and are for illustrative purposes only. While we do not doubt the floor plan accuracy and completeness, you or your advisors should conduct a careful, independent investigation of the property in respect of monetary valuation

**VIEWING BY APPOINTMENT
WITH 1ST AVENUE.**

CALL: 020 8293 8600

1stavenue
Real Estate Services