



4 Croit-E-Quill Close, Laxey, Isle of Man. IM4 7JE

Modern 3 bedroom end terrace home in a quiet cul-de-sac location.



£350,000 Freehold

PROPERTY DESCRIPTION

ACCOMODATION Situated in a quiet cul-de-sac, this property benefits from an elevated position and distant sea views toward Clay Head. The property is situated only a short drive or pleasant walk to Laxey village centre, with its shops, harbour, beach and local school.

The accommodation briefly comprises of bright and airy lounge, spacious open plan dining kitchen, 3 bedrooms plus modern bathroom. The gardens are easily managed and the rear garden is particularly private. An additional feature is a large raised partially covered decking area with seating area. Power and light connected. In addition there is a private parking area to the side of the property.

FEATURES

- Modern End Terraced Home
- Convenient Location close to Laxey Village
- Off road parking to the side of the property
- Lounge – Dining Room, Kitchen
- 3 Bedrooms
- Family Bathroom
- Gardens to Front and Rear
- Distant Sea Views



Property Images



FLOORPLAN



GROUND FLOOR
358 sq.ft. (33.2 sq.m.) approx.

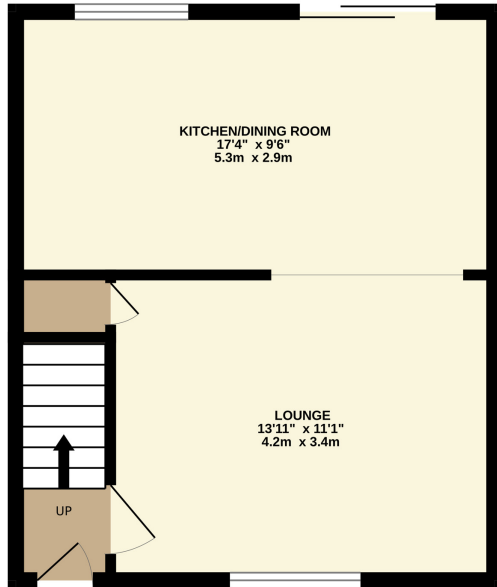

1ST FLOOR
348 sq.ft. (32.4 sq.m.) approx.

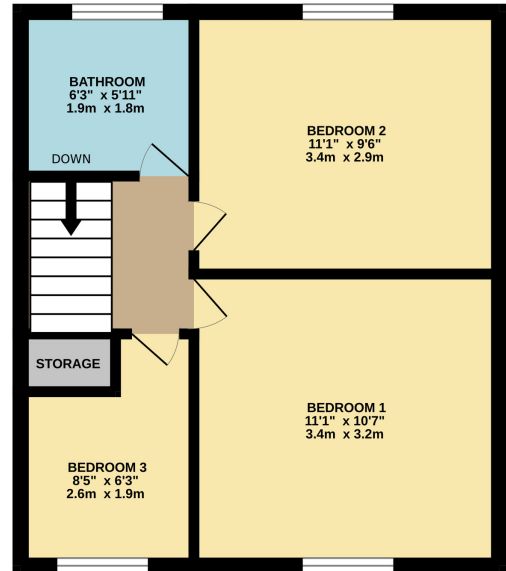

TOTAL FLOOR AREA: 706 sq.ft. (65.6 sq.m.) approx.

Whilst every attempt has been made to ensure the accuracy of the floorplan contained here, measurements of doors, windows, rooms and any other items are approximate and no responsibility is taken for any error, omission or mis-statement. This plan is for illustrative purposes only and should be used as such by any prospective purchaser. The services, systems and appliances shown have not been tested and no guarantee as to their operability or efficiency can be given.
Made with Metropix ©2025

DISCLAIMER: Whilst Manxmove Ltd believe that these details are correct, neither Manxmove Ltd or their clients guarantee their accuracy in any way. Consequently, these details are not to be used to form part of any legally binding contract. Prospective purchasers or tenants are advised to visit this property to satisfy themselves as to the correctness of these details. Please note, we use wide angle camera lenses in order to show as much of each room as possible. This is not intended to mislead any prospective purchasers or tenants in any way and an honest verbal description is always available prior to viewing if required.