

# St Marks Court

Bridgwater, TA6 5SE

COOPER  
AND  
TANNER



**£250,000 Freehold**

This charming residence offers a comfortable and modern living space in a desirable location. With its inviting interiors, well-appointed bedrooms, and convenient amenities, this property is sure to impress.

# St Marks Court

## Bridgwater

TA6 5SE

 3  1  1 EPC D

## £250,000 Freehold

### ACCOMODATION

Upon entering, you'll be welcomed by a warm and inviting atmosphere. The living room is spacious and filled with natural light, thanks to the large windows that illuminate the space. Its tasteful decor and ample room make it perfect for both relaxation and entertainment. The kitchen is modern and fully equipped, featuring sleek countertops, plenty of storage space. Offering space for a free standing fridge freezer and cooker.

The residence comprises three generously sized bedrooms, each designed to be a peaceful retreat for rest and rejuvenation. The master bedroom includes a built in wardrobe. All three bedrooms are well-appointed and share access to a well-maintained family bathroom.

### OUTSIDE

Outside, a private and low-maintenance garden awaits, offering an ideal spot for outdoor activities or simply enjoying the fresh air. It provides a serene escape within the bustling town, allowing you to unwind and relax.

### LOCATION

Conveniently located in Bridgwater, this property enjoys close proximity to a wide range of amenities, including shops, restaurants, schools, and transportation links. The town itself boasts a vibrant community atmosphere and a rich history, providing various cultural and leisure activities to explore.

### SERVICES

Mains electric, water and drainage are connected, with gas central heating installed.

### COUNCIL TAX

Band B

### VIEWING ARRANGEMENTS

Strictly via Cooper and Tanner on 01278 455255. If arriving early, please wait to be greeted by a member of our team.





# St. Marks Court, Bridgwater, TA6

Approximate Area = 944 sq ft / 87.7 sq m

Garage = 129 sq ft / 12 sq m

Total = 1073 sq ft / 99.6 sq m

For identification only - Not to scale



GROUND FLOOR

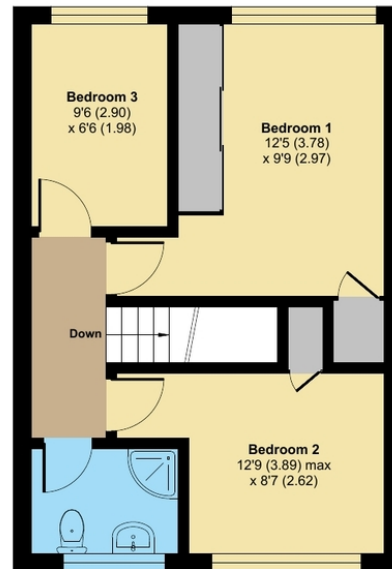

FIRST FLOOR



Floor plan produced in accordance with RICS Property Measurement Standards incorporating International Property Measurement Standards (IPMS2 Residential). © nichecom 2023. Produced for Cooper and Tanner. REF: 987625

## STREET OFFICE

Telephone 01458 840416

86, High Street, Street, Somerset BA16 0EN

[street@cooperandtanner.co.uk](mailto:street@cooperandtanner.co.uk)

COOPER  
AND  
TANNER

Important Notice: These particulars are set out as a general outline only for the guidance of intended purchasers and do not constitute, nor constitute part of, an offer or contract. All descriptions, dimensions, reference to condition and necessary permissions for use and occupation, warranties and other details are given without responsibility and any intending purchasers should not rely on the measurements or representations of fact but must satisfy themselves by inspection or otherwise as to the correctness of each of them.

