

FOR SALE

Sulgrave Road,
Hammersmith, W6

Flat
West London

£500,000 sh of fh

1  1  1 



**horton
andgarton**

SALES / LETTINGS / PROPERTY MANAGEMENT

hortonandgarton.co.uk | Sales 020 8819 0510 | Lettings 020 8819 0511
172 King Street, Hammersmith, W6 0QU



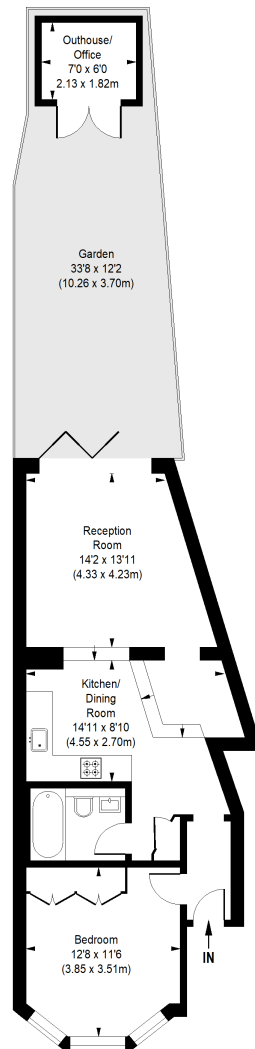

GROUND FLOOR



SULGRAVE ROAD, W6

540 Sq/ 50.17 SqM

Outhouse/ Office : 42 Sq/ 3.90 SqM

Total : 582 Sq/ 54.07 SqM

Not to scale, for guidance only and must not be relied upon as a statement of fact.
All measurements and areas are approximate only

**horton
andgarton**



Ground floor flat | 33'8 garden | 540 Sq' – 50.17 SqM |
EPC rating C | One bedroom - One bathroom |
Hammersmith



hortonandgarton.co.uk

Sales 020 8819 0510

Lettings 020 8819 0511

172 King Street, Hammersmith, W6 0QU