



Ramerick Gardens, Arlesey, Bedfordshire. SG15 6XZ





# 1 Bedroom Cluster House

## £180,000 Freehold

A modern one bedroom cluster home located on the outskirts of Arlesey within easy reach of the larger towns of Hitchin and Letchworth.

Although in need of modernisation this is a good size starter home that comprises lounge with bay window and refitted kitchen with integrated appliances to the ground floor. To the first floor is a dual aspect double bedroom with fitted wardrobes and a bathroom. For further information and your appointment to view please contact Satchells Stotfold.



- Modern cluster house
- One double bedroom
- Refitted kitchen
- Lounge with bay window
- Off road parking
- Double glazing
- Front garden
- In need of refurbishment
- Chain free
- Awaiting EPC. Council tax band B

## **Ground Floor:**

### **Front Door:**

Double glazed front door.

### **Lounge:**

Abt. 14' 7" into bay x 11' 7" (4.45m into bay x 3.53m) Double glazed bay window to side. Stairs to first floor. Coal effect living flame gas fire (not tested). Television point. Coved ceiling. Carpet as fitted.

### **Kitchen:**

Abt. 8' 8" x 6' 5" (2.64m x 1.96m) Refitted to comprise a good range of eye and base level units with ample roll edge worksurface. Single drainer stainless steel sink unit. Built-in ceramic hob, electric oven and extractor hood. Integrated fridge/freezer and washer dryer. Understairs storage cupboard. Double glazed windows to side. Inset ceiling lights. Vinyl flooring.

## **First Floor:**

### **Landing:**

Carpet as fitted.

## **Bedroom:**

Abt. 11' 9" x 11' 11" (3.58m x 3.63m) Dual aspect double glazed windows to front and side. Built-in double wardrobe. Airing cupboard. Wall mounted electric radiator. Loft access. Carpet as fitted.

## **Bathroom:**

A whisper grey coloured suite comprising panelled bath with mixer tap and shower attachment, pedestal wash hand basin and low level WC. Tiled splash areas. Double glazed window to side. Carpet as fitted.

## **Outside:**

### **Front Garden:**

Laid to lawn. Path to front door.

### **Parking:**

There is off road parking for one car.

## **Additional Information:**

### **Agents Note:**

Draft details yet to be approved by the vendor and maybe subject to change.



These particulars are a guide only and do not constitute an offer or a contract. The floor plan is for identification purposes only and not to scale. All measurements are approximate and should not be relied upon if ordering furniture, white goods and flooring etc. We have presented the property as we feel fairly describes it but before arranging a viewing or deciding to buy, should there be anything specific you would like to know about the property please enquire. Satchells have not tested any of the appliances or carried out any form of survey and advise you to carry out your own investigations on the state, condition, structure, services, title, tenure, and council tax band of the property. Some images may have been enhanced and the contents shown may not be included in the sale. Satchells routinely refer to 3rd party services for which we receive an income from their fee. If you would like us to refer you to one of these services please ask one of our staff who will pass your details on. We advise you check the availability of the property on the day of your viewing.



## Ground Floor

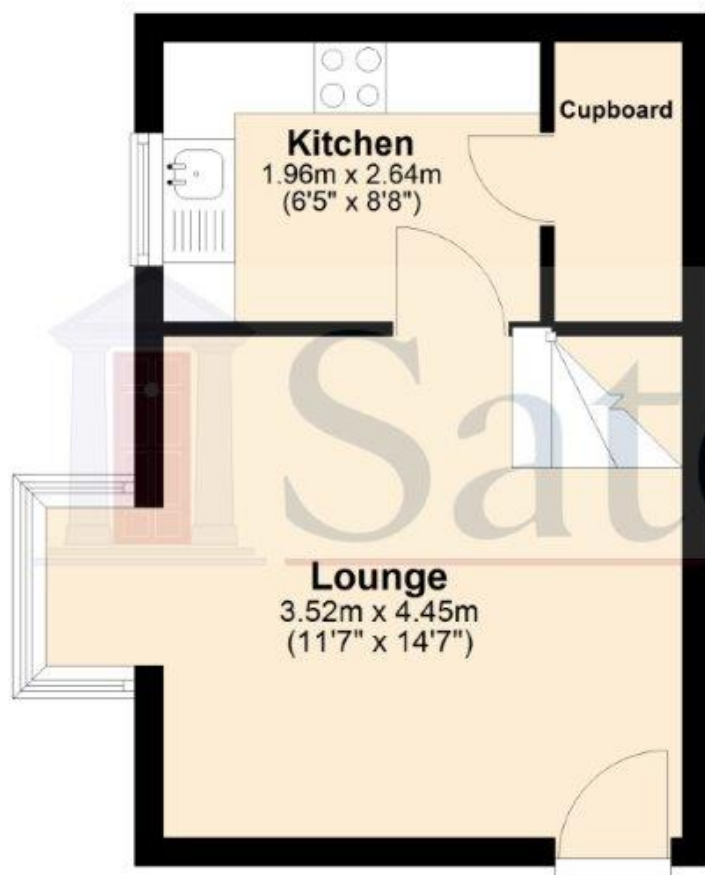

## First Floor

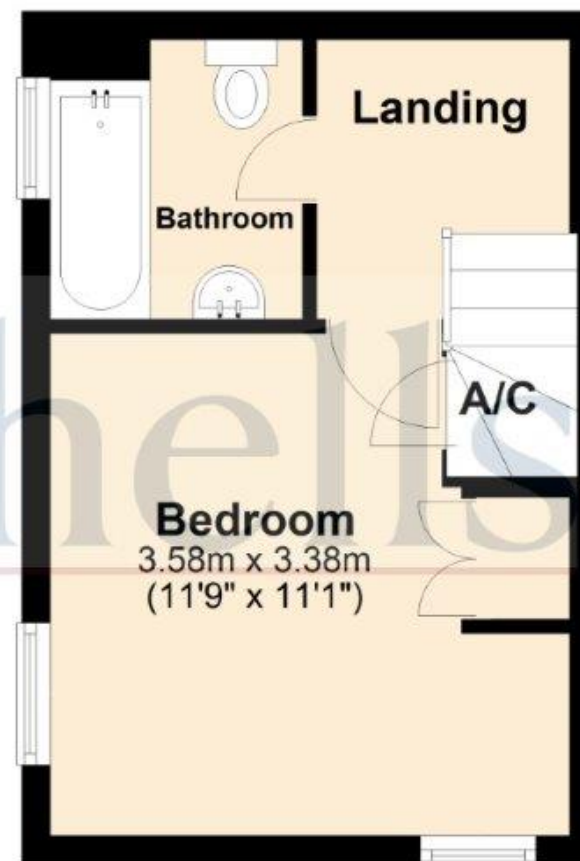

For illustration purposes only - NOT TO SCALE - Measurements shown are approximate. The size and position of doors, windows, appliances and other features are approximate.  
Plan produced using PlanUp.