



**Taurus Avenue  
North Hykeham  
Lincoln  
LN6 9FJ**

**Offers in Excess of £240,000**

**bettermove**

# Taurus Avenue Lincoln

Bettermove are proud to present this 3 bedroom Terraced House in the sought after area of North Hykeham.

The property benefits from double glazing, gas central heating throughout and has off street parking available via the driveway and the garage. The council tax band is C.

The interior of this beautifully presented property comprises a spacious living room, dining room and fitted kitchen on the ground floor. The first floor consists of X bedrooms and the family bathroom. The exterior boasts a private rear garden, perfect for enjoying the summer months.

Located in the popular town of North Hykeham, the property is close to a range of amenities, including shops, supermarkets, restaurants and pubs. Excellent transport connections can be found from Hykeham Train Station, the A46 and many local bus routes providing easy access into Lincoln City Centre.

This exciting opportunity should not be missed! All enquiries can be made through Bettermove on 0330 004 0050.



Approx Gross Internal Area  
101 sq m / 1088 sq ft

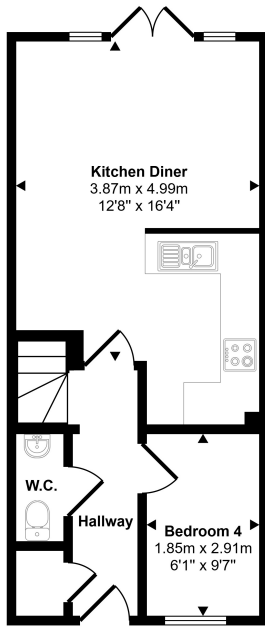

**Ground Floor**  
Approx 35 sq m / 372 sq ft

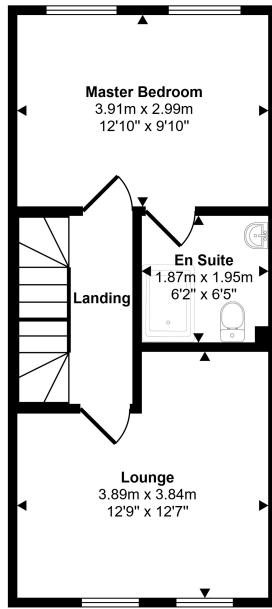

**First Floor**  
Approx 35 sq m / 382 sq ft

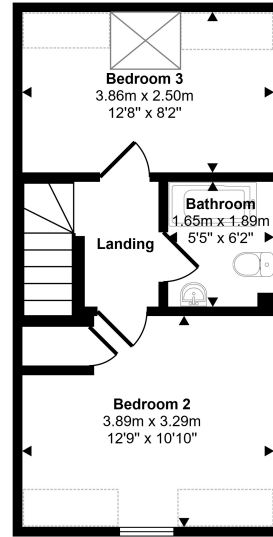

**Second Floor**  
Approx 31 sq m / 334 sq ft

Denotes head height below 1.5m

Whilst every attempt has been made to ensure the accuracy of the floor plan contained here, measurements of doors, windows, rooms and any other items are approximate and no responsibility is taken for any error, omission, or mis-statement. The measurements should not be relied upon for valuation, transaction and/or funding purposes. This plan is for illustrative purposes only and should be used as such by any prospective purchaser or tenant.



20-22 Bridge End, Leeds, LS1 4DJ  
t: 0330 004 0050 e: hello@bettermove.co.uk  
[www.bettermove.co.uk](http://www.bettermove.co.uk)