



Millacre Court | Caton





2



1



1



 lunevalley
ESTATES.



EPC -C



Band B



Freehold





Welcome to the inviting, historical and peaceful charm of Millacre Court in Caton. A residence that effortlessly combines comfort with a warm, homely ambiance. Nestled in this picturesque village setting, this property is a true gem offering a delightful living experience. As you approach down your own private lane, the bijoux manicured front garden welcomes you to a well-maintained and cosy home. The front patch of Garden is the perfect location while away long summer evenings benefitting from the evening sun!



Situated in the heart of Caton, this residence is well-connected to local amenities, schools, and scenic walking paths, making it an ideal home for those seeking both convenience and a tranquil setting. Number 3 Millacre Court is more than just a house; it's an opportunity to embrace a peaceful village lifestyle. Contact us today to schedule a viewing and envision the possibilities of making this charming property your next home in Caton.



Step through the entrance, and you'll find a thoughtfully laid-out interior that exudes a sense of tranquility and comfort.

The heart of the home lies in its spacious living room, a perfect spot for relaxation and gatherings. Large windows invite an abundance of natural light, creating a bright and inviting atmosphere. The adjacent kitchen is not only functional but also a stylish focal point, equipped with contemporary amenities that cater to your culinary needs.

Number 3 Millacre Court features two well-proportioned bedrooms, a double bedroom plays host to fitted storage units as well as a smaller space which could be a home office or single bedroom all in all, the home excels in providing ample space for family and guests. A key highlight of this property is its proximity to Lancaster and travel links via the M6





Total Approx. Floor Area 841 Sq.ft. (78.1 Sq.M.)

Surveyed and drawn by Lens Media for illustrative purposes only. Not to scale. Whilst every attempt was made to ensure the accuracy of the floor plan, all measurements are approximate and no responsibility is taken for any error.

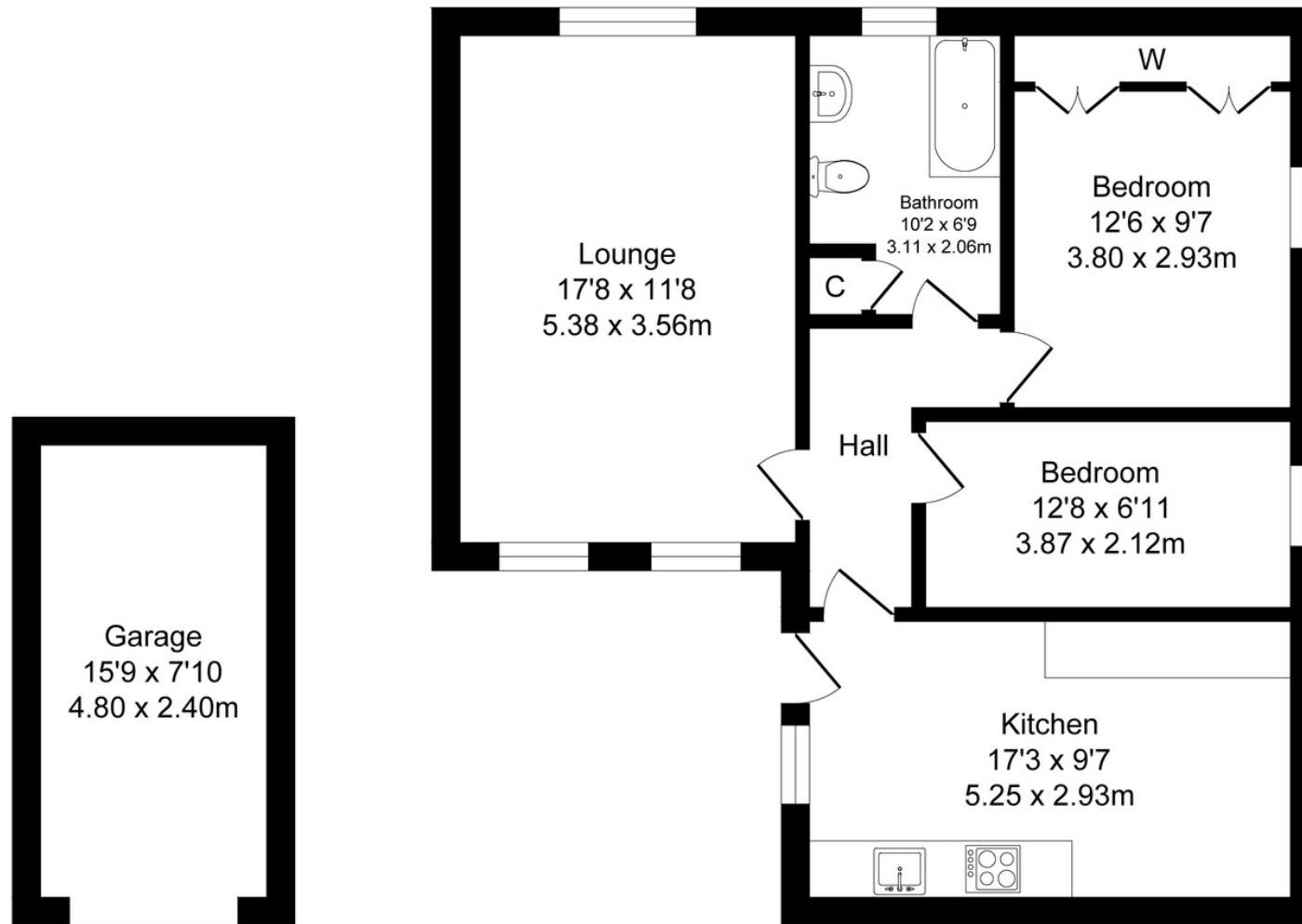

Garage

Approx. Floor Area 124 Sq.Ft (11.5 Sq.M.)

Approx. Floor Area 717 Sq.Ft (66.6 Sq.M.)

The Essentials



The Ship Inn
0.3 miles



Co-op
0.4 miles



The Station
0.4 miles



Boots
Pharmacy
0.4 miles





lunevalley

ESTATES.



Scan to visit our website!

Suite 8, Willow Mill, Caton, LA2 9RA
01524 256625
team@lunevalleyestates.com
lunevalleyestates.com