

info@kingpartners.co.uk

01366 385588

PE38 9DG

9 Market Place, Downham Market

King & Partners  
SALES • LETTINGS • MORTGAGES

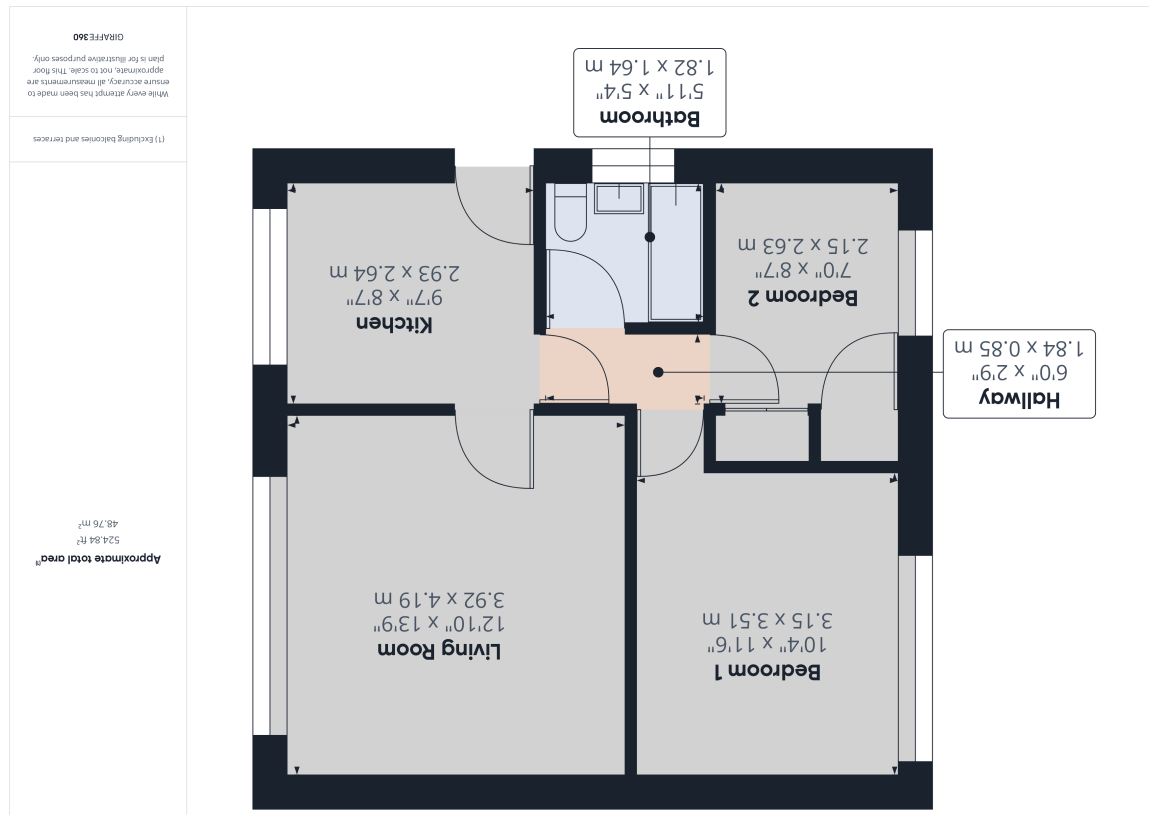

83 Maple Road  
Downham Market, PE38 9QA

£135,000

King & Partners  
SALES • LETTINGS • MORTGAGES

01366 385588  
info@kingpartners.co.uk



# Maple Road

Downham Market, PE38 9QA

This first floor maisonette is situated in a good location within Downham Market with shops and local services close by, including a mainline rail link to both Cambridge and London.

The property comprises of a living room, kitchen, two bedrooms and a bathroom. The kitchen is being refitted and there is UPVC double glazing and electric heating. Outside to the rear is an enclosed garden and access to a garage.



### Entrance Hall

Doors to all rooms.

### Living Room

12' 10" x 13' 9" (3.91m x 4.19m) UPVC Windows to rear. Electric radiator.

### Kitchen

9' 7" x 8' 7" (2.92m x 2.62m) UPVC double glazed window to rear. New kitchen to be fitted. Door to entrance stairs.

### Bathroom

5' 11" x 5' 4" (1.80m x 1.63m) UPVC double glazed window to side. Wash hand basin. Bath. W.C. Electric radiator.

### Bedroom 1

10' 4" x 11' 6" (3.15m x 3.51m) UPVC double glazed window to front.

### Bedroom 2

7' 0" x 8' 7" (2.13m x 2.62m) UPVC double glazed window to front. Cupboard. Electric radiator.

### Garden

Enclosed garden to the rear with two small storage cupboards.

### Garage

Up & Over garage doors

### Agents Note:

This is a lease hold property with 99 years remaining.

### Disclaimer

Whilst we have endeavoured to prepare our sales particulars accurately none of the services, appliances or equipment have been tested. A buyer should satisfy themselves on such matters prior to purchase. Any measurements or distances mentioned in these particulars are for guide reference only. If such particulars are fundamental to a purchase, buyers should rely on their own enquiries. All enquiries should be directed to King & Partners in the first instance.

