

FOR SALE

£825,000

Oldfield Road, Heswall, Wirral. CH60 6SG



Location Location Location! This immaculate four bedroom detached residence is beautifully positioned in one of Lower Heswall's most premium roads with some stunning views over the Dee Estuary whilst being just a short walk into Central Heswall.





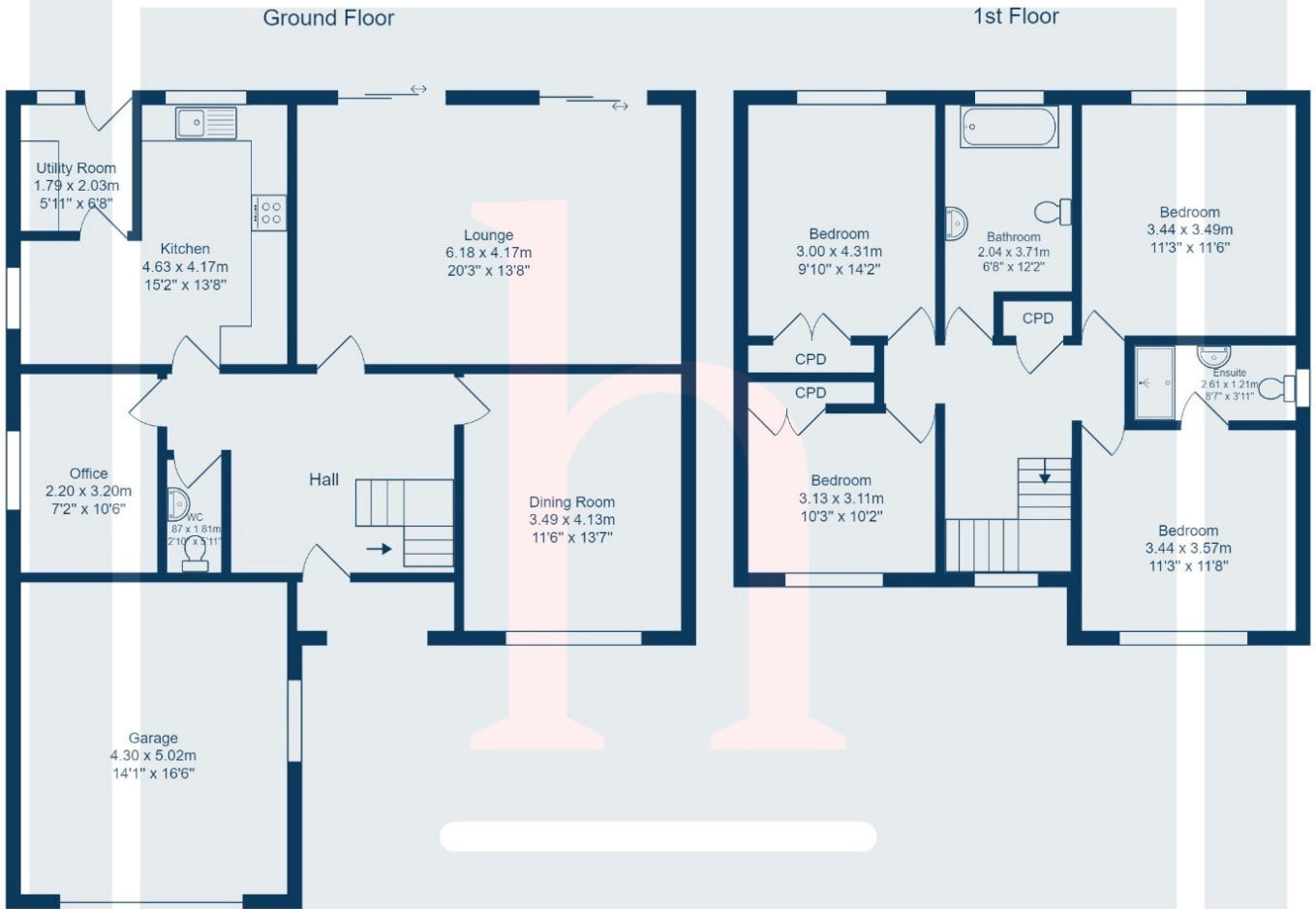

Total Area: 155.3 m² ... 1672 ft² (excluding garage)
 All measurements are approximate and for display purposes only.