



Day & Co
ESTATE AGENTS

28 Cavendish Street
Keighley
BD21 3RG



Overdale, Woodville Road,
Keighley, West Yorkshire, BD20
6JB

£435,000

T: 01535 664609

W: www.dayandcoestateagents.co.uk

E: keighley@dayandcoestateagents.co.uk

- MATURE DETACHED HOUSE
- THREE RECEPTION ROOMS
- OUTBUILDING, GARAGE

- FOUR BEDROOMS
- FRONT GARDEN, REAR YARD
- EPC RATING E

SUMMARY

** A MATURE STONE DETACHED HOUSE, FOUR BEDROOMS, THREE RECEPTION ROOMS, PART GAS CENTRAL HEATING , PART DOUBLE GLAZING, FRONT GARDEN, REAR YARD, OUTBUILDING & GARAGE, NO CHAIN, EPC RATING E **

FULL DESCRIPTION

An ideal purchase for the growing family, is this mature four bedroom detached property within good access to local schools and Keighley town centre. This property is in need of some updating, has some period features and offers a lot of potential for the buyer wanting a property to renovate. In brief the accommodation comprises of an inviting entrance hallway, Living Room with bay window to the front elevation, Sitting Room with bay window to the front elevation, Dining Room with window to the rear elevation, Dining Kitchen, Ground Floor Bathroom, Cellar. First Floor Landing - Four Double Bedrooms, House Bathroom, Washroom, W.c., Large attic with stairs from one of the bedrooms. Part Gas Central Heating & Part Double Glazing. Outside garden to the front, yard to the rear, outhouse and garage. EPC Rating E

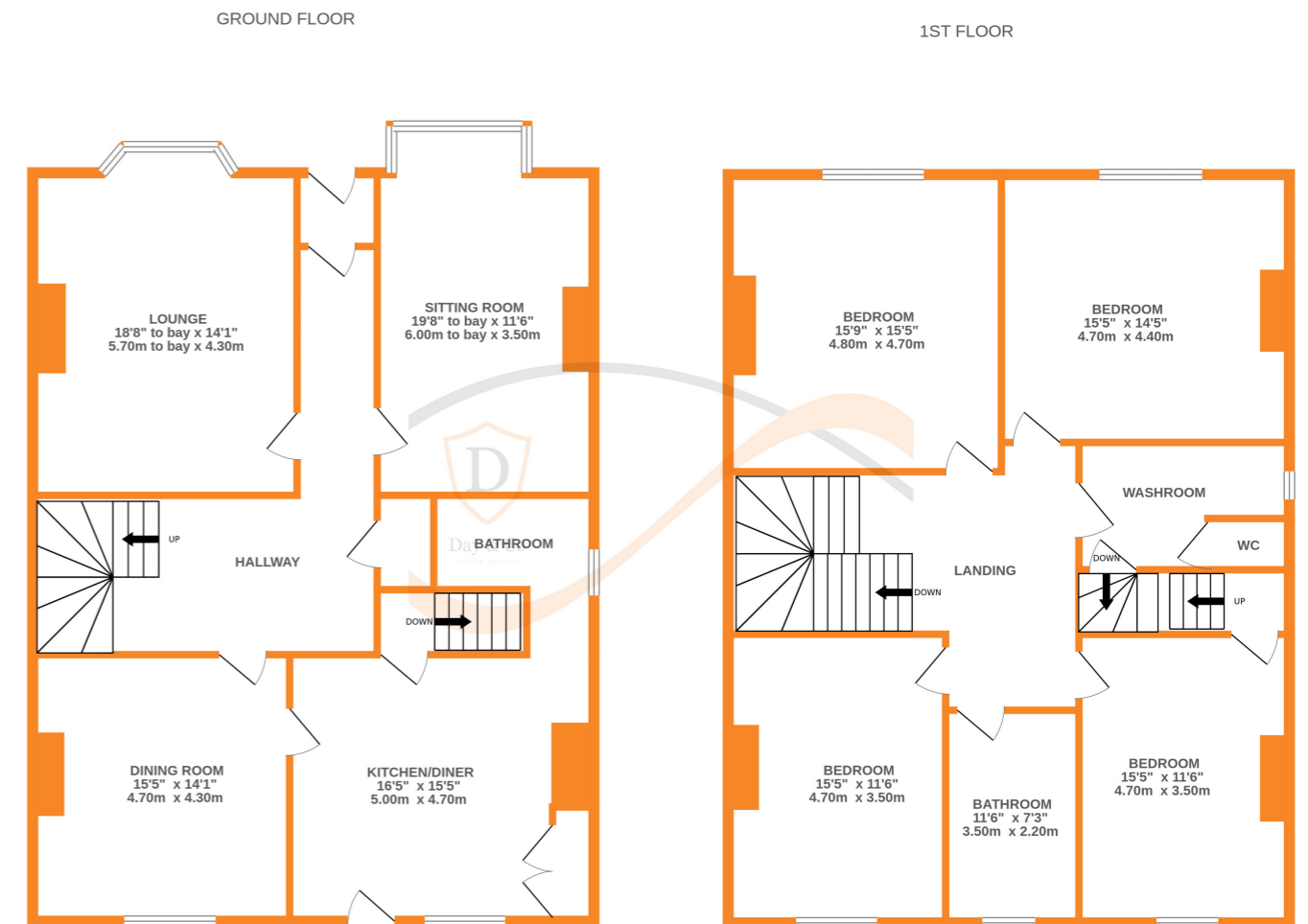

Whilst every attempt has been made to ensure the accuracy of the floorplan contained here, measurements of doors, windows, rooms and any other items are approximate and no responsibility is taken for any error, omission or mis-statement. This plan is for illustrative purposes only and should be used as such by any prospective purchaser. The services, systems and appliances shown have not been tested and no guarantee as to their operability or efficiency can be given.
Made with Metropix ©2024