

A Three-Bedroom Home with Driveway Parking in Talbot Place, Datchet – No Onward Chain

Set in a popular location within easy reach of Datchet village centre, this three-bedroom terraced home in Talbot Place offers generous space, a practical layout, and a great opportunity to make it your own.

With approximately 1,065 sq ft (99 sq m) of living space, the ground floor features a bright front-facing living room, a separate dining area, a good-sized kitchen opening onto the rear garden, and a convenient shower room. Upstairs, there are three well-proportioned bedrooms, a family bathroom, and a separate WC.

Outside, there is a good-sized front garden with driveway parking, along with a private, low-maintenance patio garden at the rear.

Talbot Place is a well-regarded residential road, just a short walk from Datchet Station (with direct trains to London Waterloo), village shops, riverside walks, and local eateries. It's also well placed for road connections, with the M4, M25 and Heathrow Airport all close by.

Offered with no onward chain, this is a fantastic opportunity to buy in a convenient, well-connected location — perfect for families, first-time buyers, or anyone looking to add value to their next home.

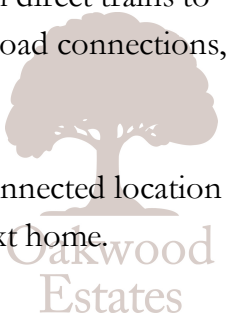

Property Information

- 

THREE BEDROOM FAMILY HOME
- 

TWO RECEPTION ROOMS
- 

POPULAR LOCATION
- 

COUNCIL TAX - BAND D
- 

TWO BATHROOMS
- 

EASY TO MAINTAIN REAR GARDEN
- 

DRIVEWAY PARKING
- 

EPC - C



x3

Bedrooms



x2

Reception Rooms



x2

Bathrooms



x3

Parking Spaces



Y

Garden



N

Garage

External

Talbot Place is a popular residential road in Datchet, known for its friendly community feel and convenient location. The property is just a short walk from Datchet village centre, where you'll find a selection of local shops, pubs, and eateries, along with riverside paths and green spaces.

Schools

Datchet St Mary's CofE Primary School
0.5 miles away State school

Eton End School Trust (Datchet) Limited
1.1 miles away Independent school
Schools
Castlevew Primary School
1.3 miles away State school

Holy Family Catholic Primary School
1.4 miles away State school

Wraysbury Primary School
1.5 miles away State school

Foxborough Primary School
1.6 miles away State school

St George's School
1.7 miles away Independent school

Ryvers School
1.7 miles away State school

Long Close School
1.7 miles away Independent school

The Queen Anne Royal Free CofE Controlled First School
1.7 miles away State school

Transport

Nearest stations:

Datchet (0.6 miles)
Sunnymeads (0.8 miles)
Windsor & Eton Riverside (1.7 miles)

Nearest Road Links:

The M4 (Junction 5) is an approx. 5 minute drive.

Council Tax

Floor Plan

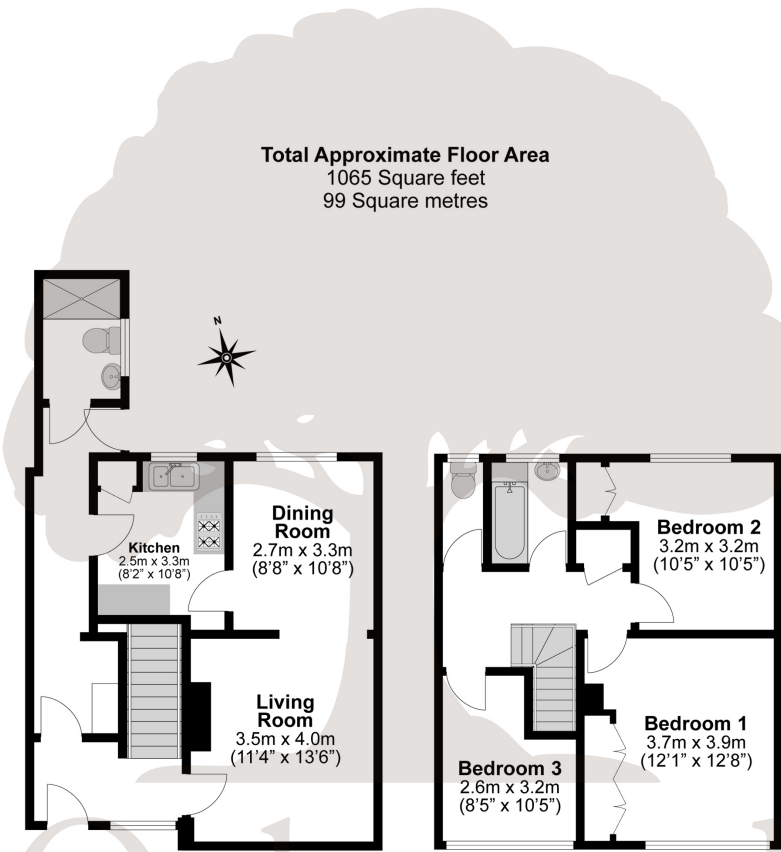

Illustrations are for identification purposes only, measurements are approximate, not to scale.

Prospective purchasers should be aware that these sales particulars are intended as a general guide only and room sizes should not be relied upon for carpets or furnishing. We have not carried out any form of survey nor have we tested any appliance or services, mechanical or electrical. All maps are supplied by Goview.co.uk from Ordnance Survey mapping. Care has been taken in the preparation of these sales particulars, which are thought to be materially correct, although their accuracy is not guaranteed and they do not form part of any contract.

