



Mora Road, Cricklewood, NW2

£465,000



Mora Road, Cricklewood, NW2

A well presented two double bedroom garden apartment offering circa 650 Sq Ft (60 Sq M) of internal space as well as an extensive 100ft private rear garden. This flat has the potential to be extended (subject to the necessary consent) and further benefits from a share of freehold and from being one of only two properties in the building.

Mora Road is perfectly located close by to the shops, local amenities and transport links found on Cricklewood Broadway and just 0.5 miles to Cricklewood train station (Thameslink).

Features

- Two Double Bedrooms
- 100ft Private Rear Garden
- Potential To Extend (subject to consent)
- Circa 650 Sq Ft (60 Sq M) Of Internal Space
- Share Of Freehold
- One Of Only Two Flats Located In The Building
- 0.5 Miles From Cricklewood Train Station
- Ideal First Time Purchase



Mora Road,
Cricklewood, NW2

Mora Road, NW2

 - Ceiling Height

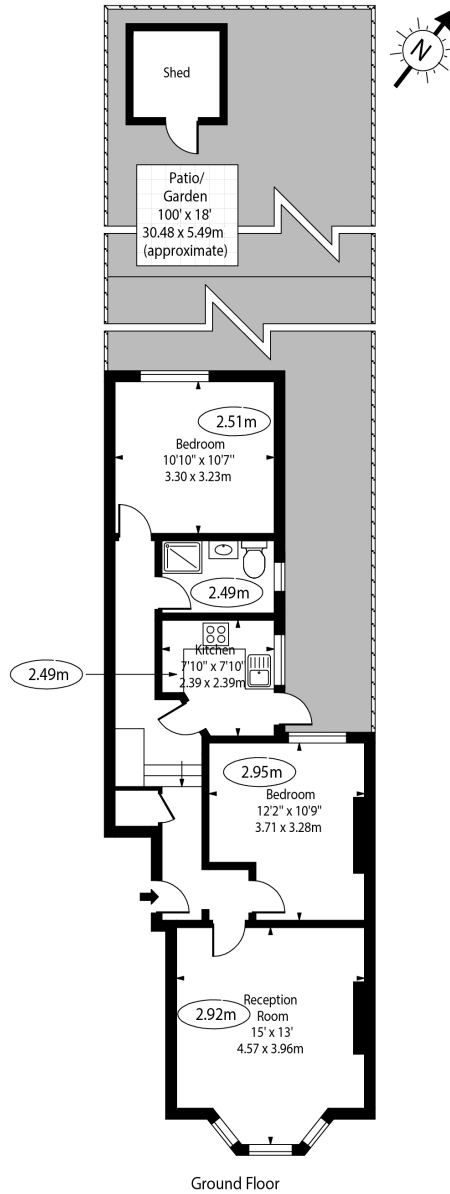

Approx Gross Internal Area 649 Sq Ft - 60.29 Sq M

(Excluding Shed)

For Illustration Purposes Only - Not To Scale Floor Plan by www.nogaphotostudio.com Ref: No.46633

This floor plan should be used as a general outline for guidance only. Any intending purchaser or lessee should satisfy themselves by inspection, searches, enquiries and full survey as to the correctness of each statement. Any areas, measurements or distances quoted are approximate and should not be used to value a property or be the basis of any sale or let.