



33 Palatine Road, Douglas, Isle of Man. IM2 3BQ

Cash buyers only - Large mid terraced home requiring renovation - Viewings Friday 14th June PM

£199,950 Freehold

PROPERTY DESCRIPTION

FEATURES

- Large Mid Terraced Home
- Cash Buyers Only
- Full Renovation Required
- Convenient Central Location
- Lounge, Dining Room plus Kitchen
- 5 Bedrooms plus Bathroom
- Small Yard To Rear

Property Images



FLOORPLAN

GROUND FLOOR
536 sq.ft. (49.8 sq.m.) approx.

1ST FLOOR
646 sq.ft. (60.0 sq.m.) approx.

2ND FLOOR
439 sq.ft. (40.7 sq.m.) approx.

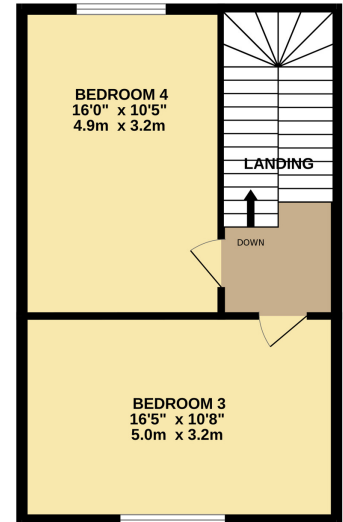
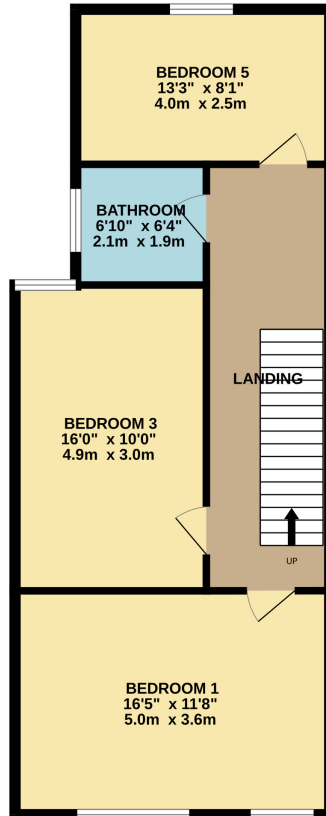
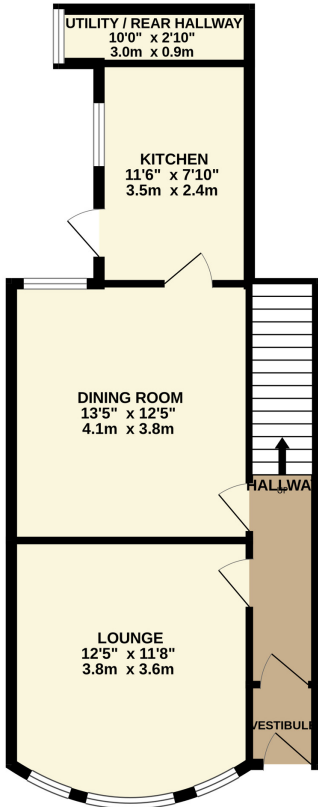

TOTAL FLOOR AREA: 1620 sq.ft. (150.5 sq.m.) approx.

Whilst every attempt has been made to ensure the accuracy of the floorplan contained here, measurements of doors, windows, rooms and any other items are approximate and no responsibility is taken for any error, omission or mis-statement. This plan is for illustrative purposes only and should be used as such by any prospective purchaser. The services, systems and appliances shown have not been tested and no guarantee as to their operability or efficiency can be given.
Made with Metropix ©2024

DISCLAIMER: Whilst Manxmove Ltd believe that these details are correct, neither Manxmove Ltd or their clients guarantee their accuracy in any way. Consequently, these details are not to be used to form part of any legally binding contract. Prospective purchasers or tenants are advised to visit this property to satisfy themselves as to the correctness of these details. Please note, we use wide angle camera lenses in order to show as much of each room as possible. This is not intended to mislead any prospective purchasers or tenants in any way and an honest verbal description is always available prior to viewing if required.