

Kingsley Close, Blackburn, Lancashire. BB2 5FB

£299,950 Leasehold

FOR SALE



stones young  
sales & lettings

Blackburn  
740, Whalley New Road, Blackburn, BB1 9BA

01254 682 470  
enquiries@stonesyoung.co.uk

## PROPERTY DESCRIPTION

BEAUTIFULLY PRESENTED FOUR BEDROOM DETACHED WITH HUGE CURB APPEAL\* Favourably positioned in the delightful location of Kingsley Close in Feniscowles stands this exquisite property, offering attractive internal accommodation completed by an extensive driveway and remarkable rear garden. Early viewing is simply essential for this impressive home.

Upon entering this versatile property through the composite front door, you are greeted by an entrance vestibule and internal hallway housing the stairs leading to the first floor. Stepping in to the inviting lounge you will instantly feel relaxed in this tastefully decorated space, featuring Karndean flooring and a wood burning stove, bringing warmth and character to the space.

Flowing beautifully from here is the second reception space, currently utilized as a dining room and office space, enjoying wonderful views of the garden which can be accessed via French doors. The stylish kitchen features ample storage in the form of base and eye level units in a high gloss white finish, with contemporary handle-less doors and integral appliances. The units are complimented by modern tiling, contrasting counter tops and lighting. The handy two piece WC in white, with a vanity unit completes the ground floor. On the first floor, leading from the landing which provides access to the boarded loft, is the serene master bedroom which due to the well appointed layout allows plenty of room for storage. The master is serviced by a three piece en-suite shower room in white. Two further generous double bedrooms are also present, along with a fourth single bedroom which is currently used as a home office with fitted furniture. Completing the internal accommodation is the three piece family bathroom suite in white, boasting a Jacuzzi bath and luxurious tiling in a high gloss grey finish.

Set on an enviable plot in this delightful location the property benefits from an extensive paved driveway which provides parking for up to four cars. Additional on street parking is also available if required. An integral single garage with power, lighting and plumbing is also present. To the rear you'll find an impressive rear garden which is a real sun trap and offers a superb space to enjoy the outdoors. Featuring composite decking and Astroturf this provides the perfect combination for all the family and is the ideal entertaining space. Feniscowles is a truly wonderful place to reside with stunning walking routes and excellent amenities nearby, as well as being within the catchment area of highly regarded schools and an inclusive community feel. Early viewing is highly advised for this elegant family home.

## FEATURES

- Four Bedroom Detached Family Home in Feniscowles
- Versatile Accommodation with Space to Work From Home
- Driveway Parking for Four Cars
- Internal Garage with Power Lighting and Plumbing for Washing Machine
- Stunning Kitchen with Gloss Handleless Cupboards
- Two Beautiful Reception Rooms
- Triple Glazing Throughout
- Sun Drenched Beautifully Maintained Rear Garden
- Council Tax Band D



## ROOM DESCRIPTIONS

### Ground Floor

#### Vestibule

Mat flooring, composite front door, uPVC double glazed window, garage access, panel radiator

#### Internal Hallway

Carpet flooring, stairs to first floor

#### Lounge

18' 11" x 11' 11" (5.77m x 3.63m)

Karndean flooring, wood burning stove with store, flagged hearth, ceiling coving, uPVC double glazed window, panel radiator, TV point, phone point

#### Dining Room

10' 11" x 09' 06" (3.33m x 2.90m)

Karndean flooring, ceiling coving, uPVC double glazed French doors.

#### Kitchen

09' 05" x 09' 04" (2.87m x 2.84m)

Range of fitted wall and base units with contrasting worksurfaces, integral fridge freezer, dishwasher, electric oven, gas hob, one and a half stainless steel sink and drainer, extractor fan, tiled splashbacks, composite door to garden, under stair storage, Karndean flooring, uPVC double glazed window

#### WC

07' 00" x 03' 01" (2.13m x 0.94m)

Two piece in white, vanity unit housing sink, lino flooring, heated towel radiator, uPVC double glazed window

### First Floor

#### Landing

Carpet flooring, spindle ballustrade, loft access to loft with power and lighting, airing cupboard, uPVC double glazed window

### En-Suite

08' 04" x 02' 09" (2.54m x 0.84m)

Three piece suite in white with shower enclosure and mainsfed shower, tiled splashbacks, Lino flooring, uPVC double glazed frosted window

### Bedroom 1

15' 09" x 10' 00" (4.80m x 3.05m)

Carpet flooring, uPVC double glazed window, panel radiator

### Bedroom 2

12' 07" x 10' 07" (3.84m x 3.23m)

Carpet flooring, ceiling coving, uPVC double glazed window, panel radiator

### Bedroom 3

10' 00" x 09' 01" (3.05m x 2.77m)

Carpet flooring, uPVC double glazed window, panel radiator

### Bedroom 4

09' 04" x 06' 06" (2.84m x 1.98m)

Carpet flooring, uPVC double glazed window, built in office furniture, panel radiator

### Bathroom

06' 00" x 06' 00" (1.83m x 1.83m)

Three piece in white, mainsfed shower over Jacuzzi bath, tiled floor to ceiling, panelled ceiling with spotlights, lino flooring, heated towel radiator, uPVC double glazed frosted window



# FLOORPLAN & EPC

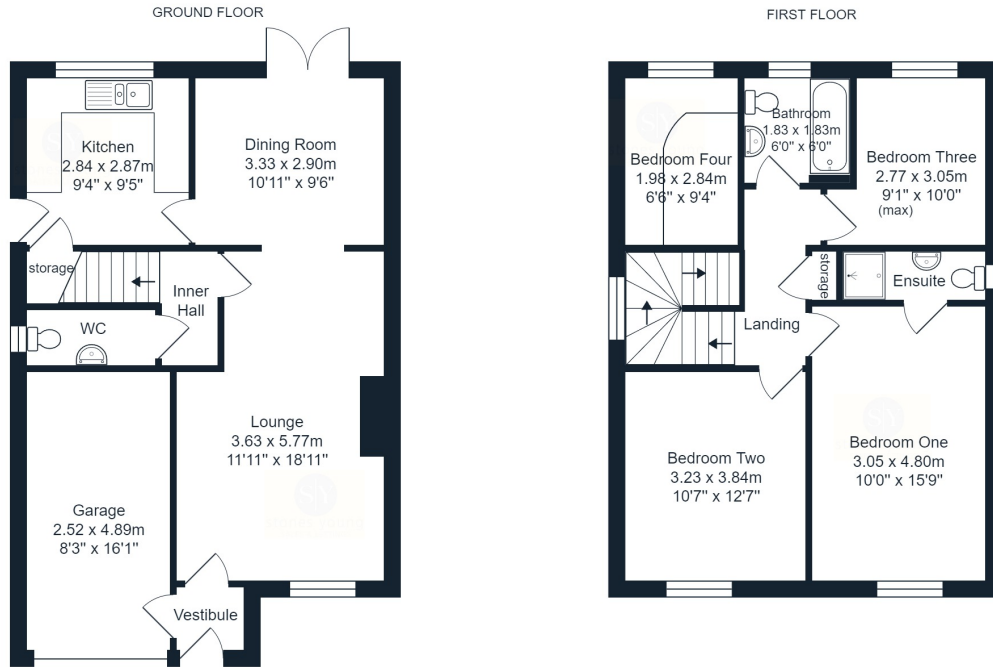

## Kingsley Close, Blackburn

Total Area: 116.3 m<sup>2</sup> ... 1252 ft<sup>2</sup>

All measurements are approximate and for display purposes only.

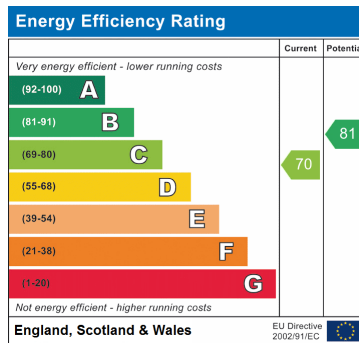

These particulars are intended to give a fair and reliable description of the property but no responsibility for any inaccuracy or error can be accepted and do not constitute an offer or contract. We have not tested any services or appliances (including central heating if fitted) referred to in these particulars and the purchasers are advised to satisfy themselves as to the working order and condition. If a property is unoccupied at any time there may be reconnection charges for any switched off/disconnected or drained services or appliances. All measurements are approximate.

