



Day & Co  
ESTATE AGENTS

28 Cavendish Street  
Keighley  
BD21 3RG



12 Mitchell Terrace, Bingley,  
West Yorkshire, BD16 1ER

£179,995

T: 01535 664609

W: [www.dayandcoestateagents.co.uk](http://www.dayandcoestateagents.co.uk)

E: [keighley@dayandcoestateagents.co.uk](mailto:keighley@dayandcoestateagents.co.uk)



- THROUGH TERRACE
  - ACCOMMODATION OVER 3 FLOORS
  - REAR YARD
- TWO BEDROOMS & STUDY
  - GAS CENTRAL HEATING & DOUBLE GLAZING
  - EPC RATING D

SUMMARY

\*\* MID STONE THROUGH TERRACE, TWO BEDROOMS & STUDY, LOUNGE & DINING KITCHEN, ACCOMMODATION OVER THREE FLOORS, GAS CENTRAL HEATING, DOUBLE GLAZING, REAR YARD, EPC RATING D \*\*

FULL DESCRIPTION

A mid stone terrace offering two bedrooms plus study situated in a popular Bingley location. This property may appeal to a variety of buyers with the accommodation planned over three floors briefly comprising -

Ground Floor - Living room with fireplace, a door at the rear of the room provides access to the kitchen diner, modern range of units space for a dishwasher and washing machine. A staircase leads either down to the cellar or up to the first floor. From the kitchen the rear yard can be accessed.

First Floor - Landing, Large bedroom with built in wardrobes either side of the chimney breast. The house bathroom is at the rear of the property and is equipped with a toilet, basin and bath with shower above. The study is located between the bedroom and bathroom.

Second Floor - Large attic bedroom with roof window to the front.

Gas Central Heating & Double Glazing.

Outside - Yard to the rear.

The property is delightfully situated in a popular and convenient residential location on the edge of Bingley town centre. Bingley town centre offers a range of shops and amenities, bars, restaurants and well respected primary and secondary schools. The location is also well served by excellent road and rail access.

EPC Rating D

GROUND FLOOR

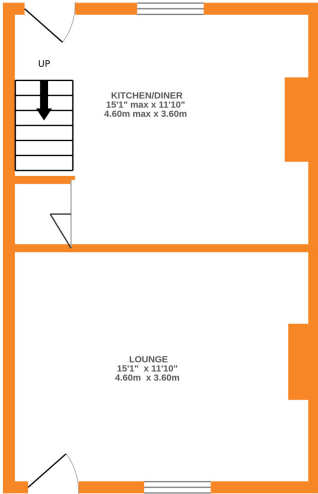

1ST FLOOR

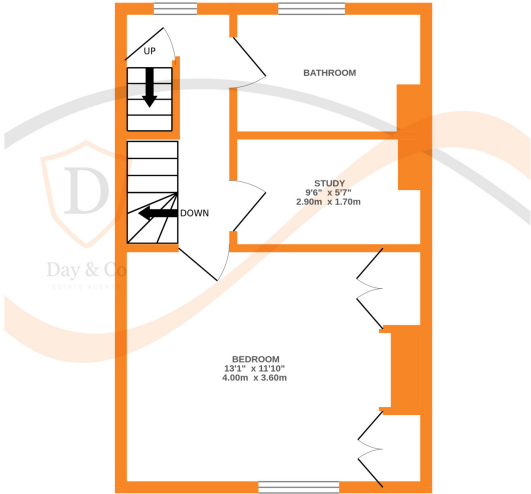

2ND FLOOR

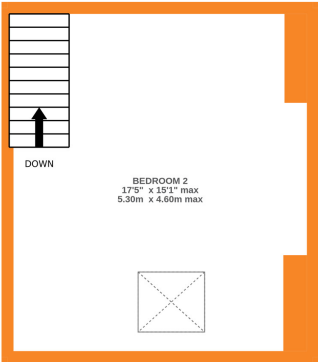

Whilst every attempt has been made to ensure the accuracy of the floorplan contained here, measurements of doors, windows, rooms and any other items are approximate and no responsibility is taken for any error, omission or mis-statement. This plan is for illustrative purposes only and should be used as such by any prospective purchaser. The services, systems and appliances shown have not been tested and no guarantee as to their operability or efficiency can be given.  
Made with Metropix ©2025