



Day & Co  
ESTATE AGENTS

28 Cavendish Street

Keighley

BD21 3RG



14 East Terrace, Cross Roads,  
Keighley, West Yorkshire, BD22  
9EL

£119,995

T: 01535 664609

W: [www.dayandcoestateagents.co.uk](http://www.dayandcoestateagents.co.uk)

E: [keighley@dayandcoestateagents.co.uk](mailto:keighley@dayandcoestateagents.co.uk)

- TWO BED TERRACE
- POPULAR AREA
- EPC RATING E

- CLOSE TO LOCAL PRIMARY SCHOOL
- SMALL REAR YARD

## SUMMARY

\*\*STONE BUILT TERRACE PROPERTY IS THIS EVER POPULAR RESIDENTIAL LOCATION CLOSE TO LOCAL FIRST SCHOOL, POPULAR AREA OF CROSS ROADS, GAS CENTRAL HEATING, DOUBLE GLAZING, SMALL YARD AREA TO THE REAR, COULD SUIT A VARIETY OF BUYERS, EARLY VIEWING RECOMMENDED, EPC Rating E \*\*

## FULL DESCRIPTION

Day & Co are pleased to be marketing for sale this two bedroom stone terrace situated in the popular residential village of Cross Roads with its range of amenities and popular first school. The property benefits from double glazing & gas central and has accommodation briefly comprising of a Living Room with entrance vestibule and window to the front, Dining Kitchen with range of base & wall units and under stairs store. To the first floor are 2 bedrooms and completing the accommodation is the Bathroom which has a 3 piece suite and window to the rear. To the rear of the property is a small enclosed yard. EPC rating E.

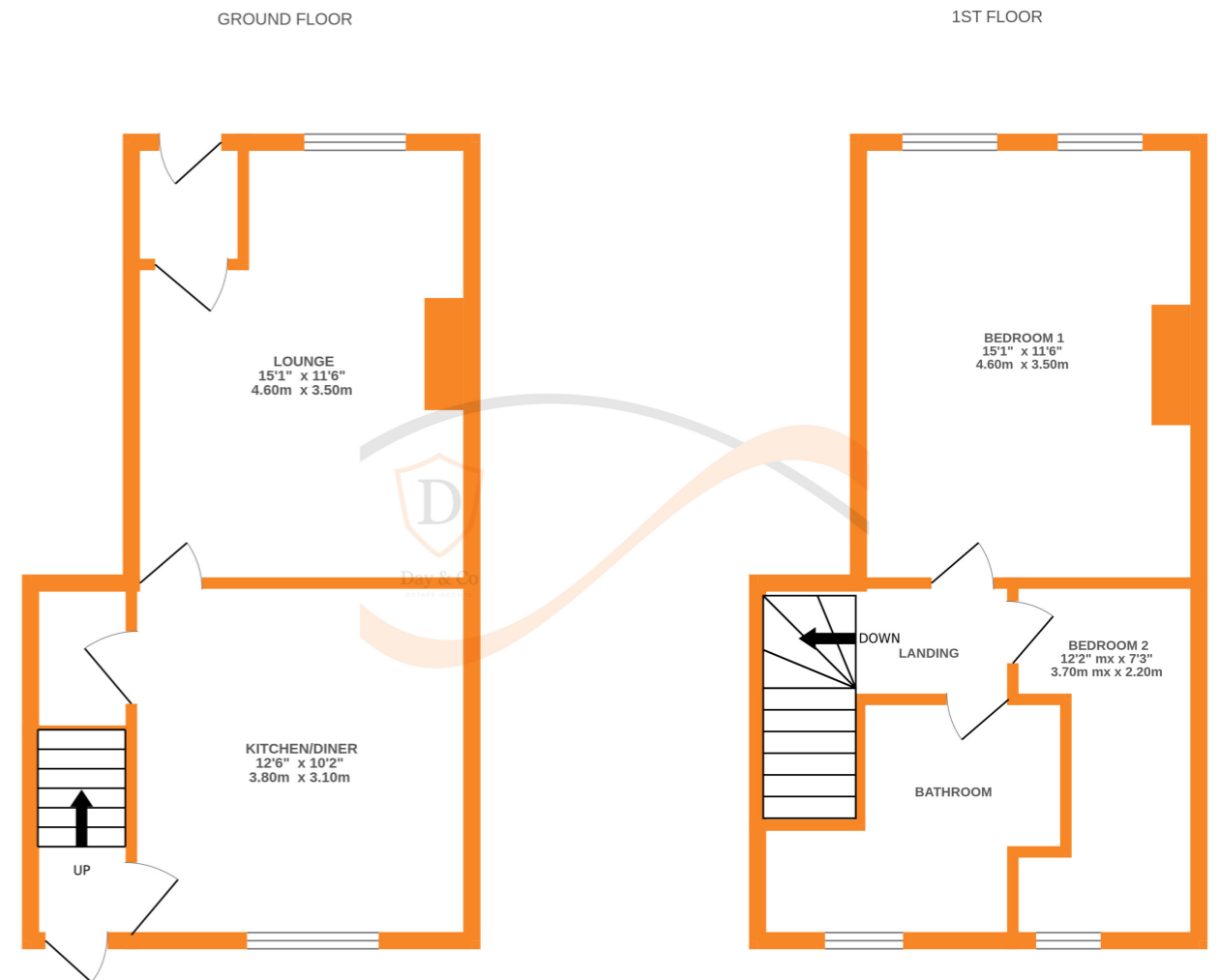

Whilst every attempt has been made to ensure the accuracy of the floorplan contained here, measurements of doors, windows, rooms and any other items are approximate and no responsibility is taken for any error, omission or mis-statement. This plan is for illustrative purposes only and should be used as such by any prospective purchaser. The services, systems and appliances shown have not been tested and no guarantee as to their operability or efficiency can be given.  
Made with Metropix ©2024