



Pearl Court, Whitehorse Street, Baldock, Hertfordshire. SG7 6XR







## 2 Bedroom Apartment

### £300,000 Share of Freehold

Satchells Estate Agents presents you with this beautiful second floor apartment consisting of living/dining area, two double bedrooms, family bathroom and allocated parking. Centrally located within strolling distance to the train station and Baldock's historic high street. This property benefits with it's loft extension allowing the potential of a third bedroom. The property also offers itself as Share of Freehold and chain free! Viewing highly recommended.

- Second floor apartment
- Allocated parking
- Town centre location
- Chain free
- Loft extension
- Potential third bedroom
- Good condition
- Share of freehold
- Viewing recommended
- EPC rating D. Council tax band C

**Ground Floor:****Entrance:**

Via communal front door. Stairs to second floor.

**Second Floor:****Lounge:**

Abt. 16' 0" x 18' 0" (4.88m x 5.49m) Two double glazed windows to front aspect. Fitted carpets. Radiator.

**Kitchen:**

Abt. 7' 5" x 10' 5" (2.26m x 3.17m) Range of fitted wall and base units. Overhead extractor fan. Plumbing for washing machine. Sink and drainer. Double glazed window to side aspect.

**Bedroom One:**

Abt. 14' 5" x 9' 5" (4.39m x 2.87m) Two double glazed windows to side aspect. Fitted carpet. Radiator.

**Bedroom Two:**

Abt. 9' 0" x 9' 0" (2.74m x 2.74m) Double glazed window to front aspect. Fitted carpet. Radiator.

**Bathroom:**

Suite comprising panelled bath, low level WC and pedestal wash hand basin. Tiled flooring.

**Upstairs:****Loft Conversion:**

Three Velux windows to either aspect.

**Additional Information:****Agents Note:**

Draft details yet to be approved by the vendor and may be subject to change.

## Second Floor

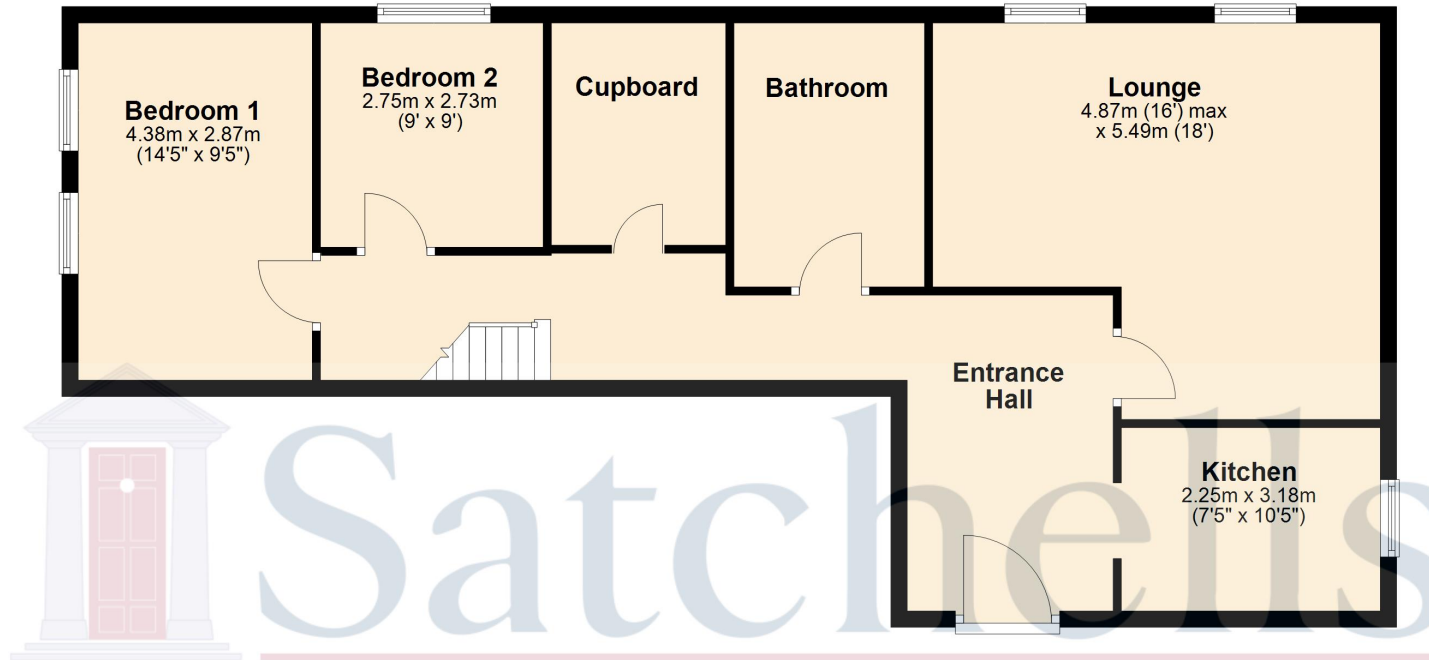

## Loft Conversion

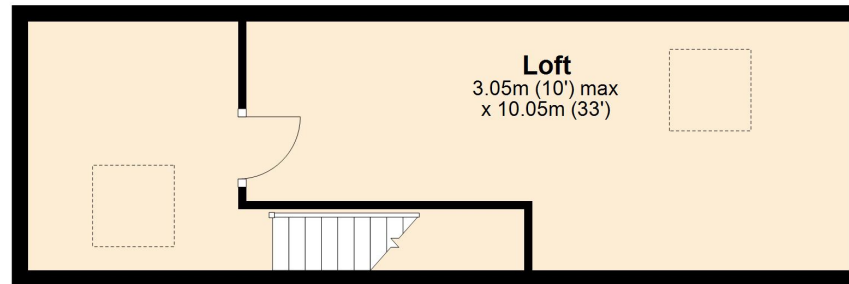

For illustrative purposes only - NOT TO SCALE - Measurements shown are approximate.  
The size and position of doors, windows, appliances and other features are approximate.

Plan produced using PlanUp.