



13 Brisbane Street, Douglas, Isle of Man. IM1 3JH

A spacious traditional town house situated close to amenities with rear garden and off road parking.



£339,950 Freehold

PROPERTY DESCRIPTION

ACCOMMODATION This traditional period town house is located close to the amenities of town and offers spacious family accommodation over two floors.

On the ground floor there is an entrance vestibule leading into a traditional hallway providing access into the lounge which faces front and is open plan into the dining room behind. A clear spayed opening provides access into the breakfast area and fitted kitchen which leads into a small utility room. From the breakfast area a sliding patio door provides access onto a small patio with steps up to a lawned garden and off road parking area.

On the first floor there are 4 bedrooms (1 En-Suite) plus family bathroom. An enclosed staircase provides access to a substantial boarded attic space.

This property is offered with no onward chain and an internal inspection is recommended.

FEATURES

- Traditional Town House
- Town Centre Location
- Close to Amenities
- Open Plan lounge/Diner
- Kitchen with Breakfast Area
- 4 Bedrooms (1 En Suite) plus Bathroom
- Front and Rear Garden
- Off Road Parking to Rear
- No Onward Chain



Property Images



FLOORPLAN



GROUND FLOOR
595 sq.ft. (55.3 sq.m.) approx.

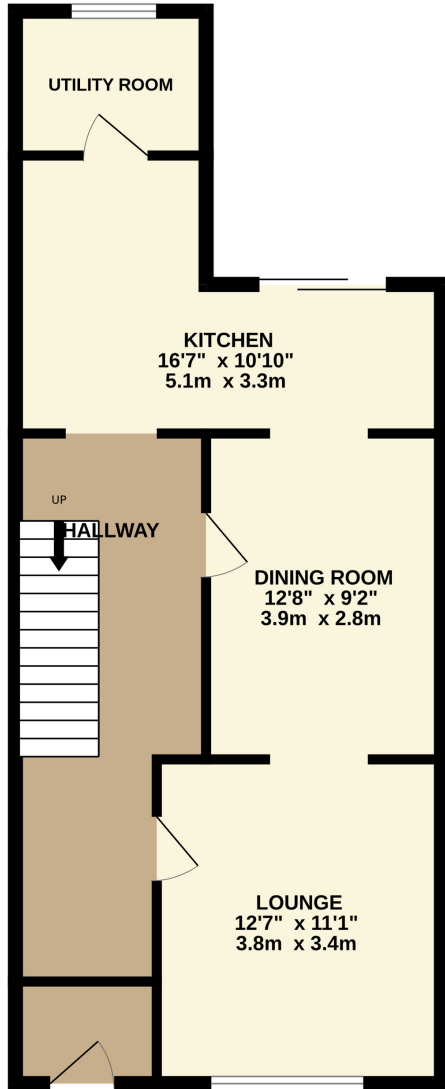

1ST FLOOR
640 sq.ft. (59.5 sq.m.) approx.

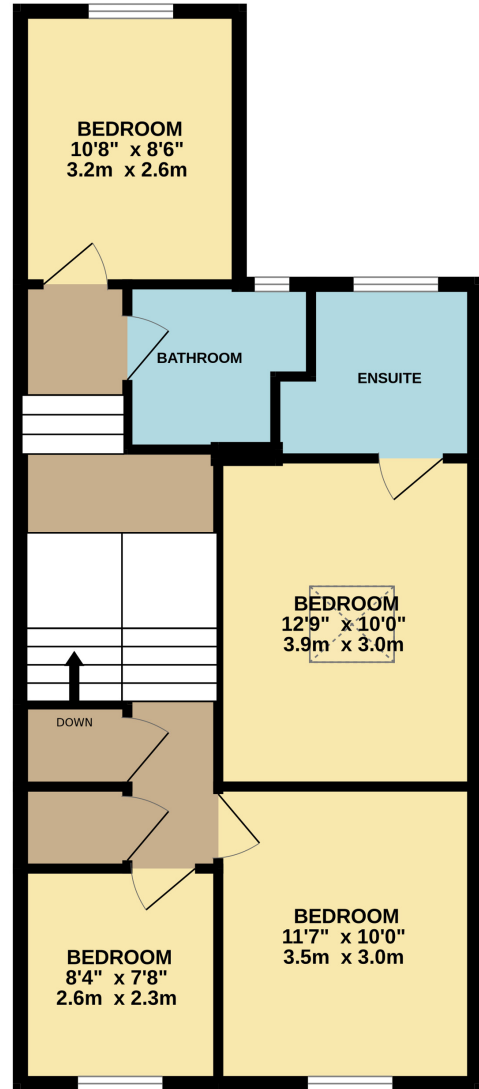

TOTAL FLOOR AREA : 1236 sq.ft. (114.8 sq.m.) approx.

Whilst every attempt has been made to ensure the accuracy of the floorplan contained here, measurements of doors, windows, rooms and any other items are approximate and no responsibility is taken for any error, omission or mis-statement. This plan is for illustrative purposes only and should be used as such by any prospective purchaser. The services, systems and appliances shown have not been tested and no guarantee as to their operability or efficiency can be given.
Made with Metropix ©2025

DISCLAIMER: Whilst Manxmove Ltd believe that these details are correct, neither Manxmove Ltd or their clients guarantee their accuracy in any way. Consequently, these details are not to be used to form part of any legally binding contract. Prospective purchasers or tenants are advised to visit this property to satisfy themselves as to the correctness of these details. Please note, we use wide angle camera lenses in order to show as much of each room as possible. This is not intended to mislead any prospective purchasers or tenants in any way and an honest verbal description is always available prior to viewing if required.