

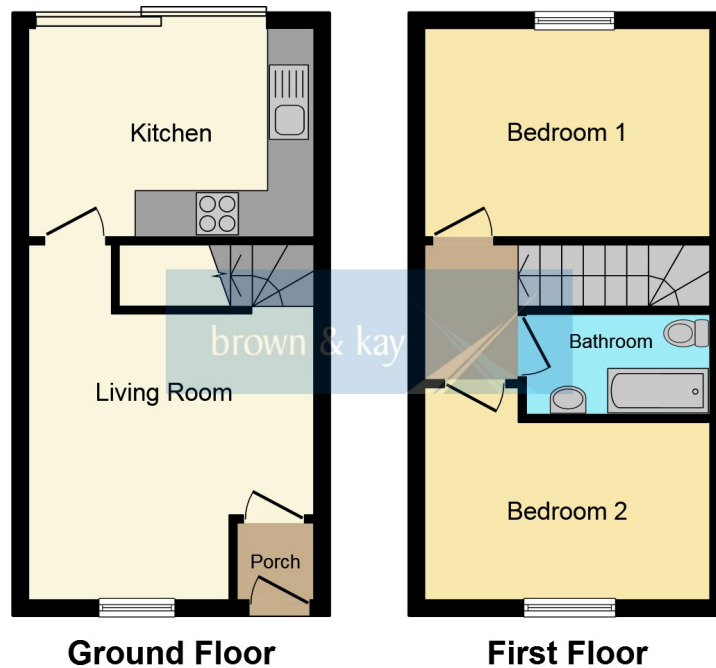

44 SPRUCE CLOSE, CREEKMOOR, DORSET BH17 7YT

Offers Over £240,000

- NO FORWARD CHAIN
- IN NEED OF MODERNISATION
- SOUGHT AFTER LOCATION
- TWO DOUBLE BEDROOMS
- OFF ROAD PARKING
- IDEAL BUY TO LET OR FIRST TIME BUY



This floor plan is for illustration purposes only and may not be representative of the property. The position and size of doors, windows and other features are approximate. Unauthorized reproduction prohibited. © PropertyBOX

Brown and Kay are delighted to market this two double bedroom mid-terraced house located in the sought after area of Creekmoor. The property is being sold with no forward chain and thus would make an ideal buy to let or first time buy!

ENTRANCE PORCH

LIVING ROOM

15' 10" x 12' 04" (4.83m x 3.76m)
window overlooking the front garden,
stairs up to first floor.

KITCHEN

12' 04" x 9' 03" (3.76m x 2.82m) UPVC
sliding doors to the garden, mix of base
and eye level units

BEDROOM ONE

12' 04" x 8' 10" (3.76m x 2.69m)

BEDROOM TWO

12' 04" x 7' 03" (3.76m x 2.21m)

BATHROOM

REAR GARDEN

COUNCIL TAX - BAND C

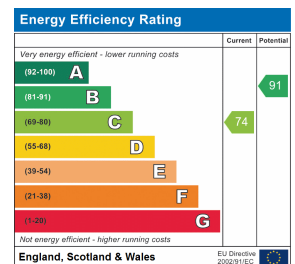

These particulars, whilst believed to be accurate are set out as a general outline only for guidance and do not constitute any part of an offer or contract. Intending purchasers should not rely on them as statements or representation of fact, but must satisfy themselves by inspection or otherwise as to their accuracy. We have not carried out a detailed survey nor tested the services, appliances and specific fittings. Room sizes should not be relied upon for carpets and furnishings. The measurements given are approximate. No person in this firms employment has the authority to make or give any representation or warranty in respect of the property.