



25, Sanderling Close

Letchworth Garden City,  
Hertfordshire, SG6 4HY  
£260,000

COUNTRY PROPERTIES

PART OF HUNTERS

A two bedroom mid terrace home located on the very edge of Letchworth close to Standalone Farm and open countryside. The property itself requires some modernisation and updating and is offered with no upper chain.

On the ground floor there is a lounge and a good size kitchen/dining room overlooking the rear garden. The floors has two bedrooms and bathroom. Throughout is electric heating and double glazed windows.

The property is conveniently located within walking distance of the town centre, where you can find a range of amenities, including the trains station, shops, restaurants, and local attractions. It's worth noting that Letchworth Garden City is known for its unique town planning and beautiful green spaces, which add to its charm.

- Double glazed throughout
- Electric heating.
- Spacious kitchen/diner overlooking the garden.
- Two good size double bedrooms
- Private rear garden with gated access to rear
- Allocated off road parking space
- Offered with vacant possession and no upper chain.





## Ground Floor

Approx. 27.9 sq. metres (300.7 sq. feet)

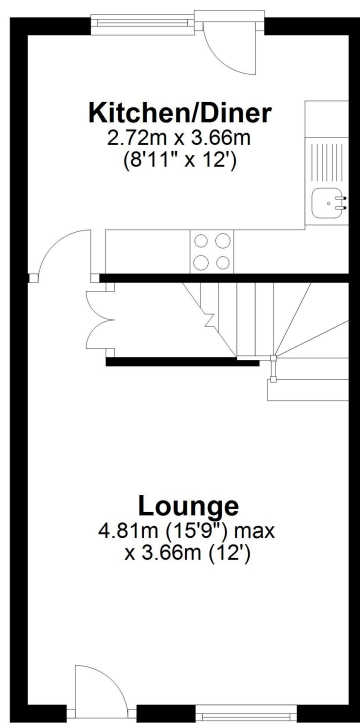

## First Floor

Approx. 27.9 sq. metres (300.7 sq. feet)

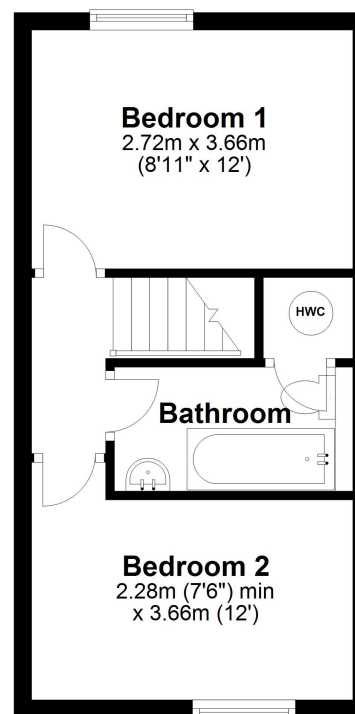

Total area: approx. 55.9 sq. metres (601.3 sq. feet)

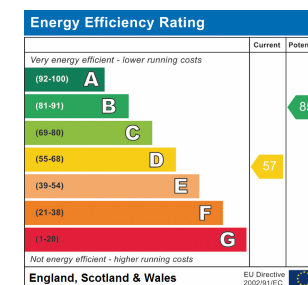

All measurements are approximate and quoted in metric with imperial equivalents and for general guidance only and whilst every attempt has been made to ensure accuracy, they must not be relied on. The fixtures, fittings and appliances referred to have not been tested and therefore no guarantee can be given and that they are in working order. Internal photographs are reproduced for general information and it must not be inferred that any item shown is included with the property. For a free valuation, contact the numbers listed on the brochure.

Viewing by appointment only

Country Properties | 7, Howard Park Corner | SG6 1PQ

T: 01462 481100 | E: [simon.ellmers@country-properties.co.uk](mailto:simon.ellmers@country-properties.co.uk)

[www.country-properties.co.uk](http://www.country-properties.co.uk)

**COUNTRY PROPERTIES**  
PART OF **HUNTERS**