

# Truuli



## Bute Road, Croydon, Surrey, CR0

£400,000 Freehold

- Well maintained family home
- Upstairs bathroom and downstairs WC
- En suite shower room
- Close to Purley way retail park
- Close to Wandle Park and Waddon Ponds
- Guide price £400,000 - £425,000

2, Lansdowne Road, Croydon, Surrey, CR9 2ER

Tel: 0330 043 0002

Email: [save@truuli.co.uk](mailto:save@truuli.co.uk) Web: [www.truuli.co.uk](http://www.truuli.co.uk)

# Bute Road, Croydon, Surrey, CR0

£400,000 Freehold

\*\*\* Guide price £400,000 - £425,000 \*\*\* A charming two double bedroom period property which has bright and airy accommodation throughout. The house has a large private garden and is conveniently located for transport.

Ground Floor  
499 sq.ft. (46.4 sq.m.) approx.

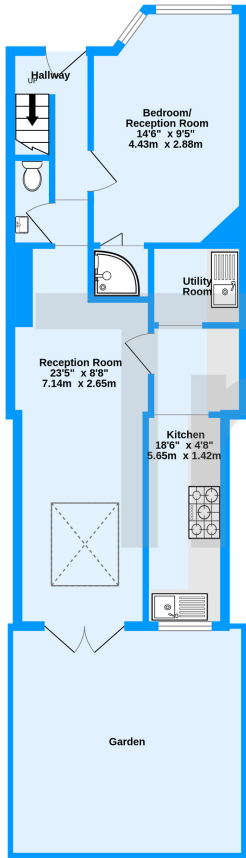

1st Floor  
341 sq.ft. (31.6 sq.m.) approx.

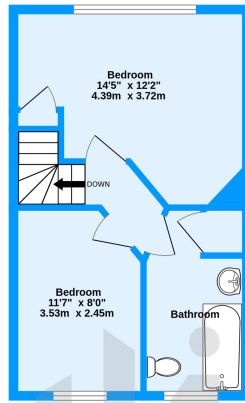

TOTAL FLOOR AREA: 840 sq.ft. (78.0 sq.m.) approx.  
Measurements are approximate. Not to scale. Illustrative purposes only  
Made with Metropix ©2023

