



## Allingham Court, Haverstock Hill, Belsize Park, NW3

£3,250  
pcm



## Allingham Court, Haverstock Hill, Belsize Park, NW3

Situated in the heart of Belsize Park is this well proportioned three bedroom apartment located on the third floor (with lift) of a well maintained building. This superb flat benefits from a spacious reception room, contemporary kitchen, two double bedrooms and a single third bedroom/study. Further key features include ample storage, a modern bathroom and an additional WC.

\*Only Available To A Maximum Of Two Sharers Or One Family \*Offered Unfurnished \*Available From 11th February 2026.

Allingham Court is perfectly located moments from the local amenities on Haverstock Hill with Belsize Park underground station (Northern Line) just 150 ft away. Both Primrose Hill & Hampstead Heath are situated within easy reach as well.

\*Please note that virtual furniture is included within the marketing photos.

### Features

- Situated In The Heart Of Belsize Park
- Third Floor (with lift)
- Well Proportioned Apartment
- Two Double Bedrooms + Single/Study
- Contemporary Kitchen
- Modern Bathroom + Additional WC
- Ample Storage
- Offered Unfurnished
- Available From 11th February 2026







Allingham Court,  
Haverstock Hill,  
Belsize Park, NW3

Allingham Court,  
Haverstock Hill, NW3

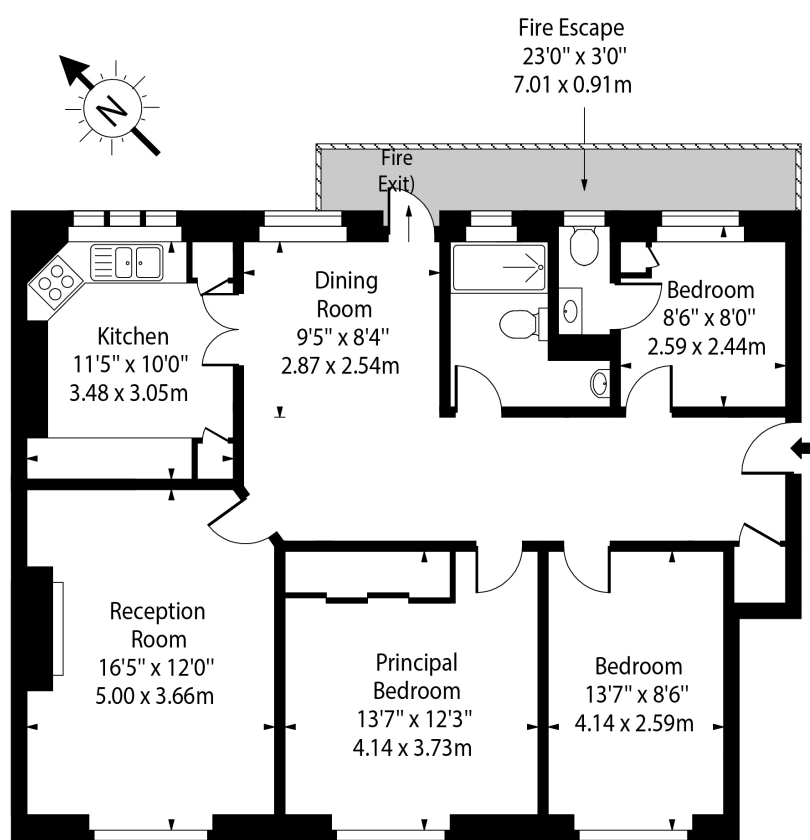

Third Floor

Approx Gross Internal Area 1034 Sq Ft - 96.06 Sq M

For Illustration Purposes Only - Not To Scale Floor Plan by [www.nogaphotostudio.com](http://www.nogaphotostudio.com) Ref: No.42422

This floor plan should be used as a general outline for guidance only. Any intending purchaser or lessee should satisfy themselves by inspection, searches, enquiries and full survey as to the correctness of each statement. Any areas, measurements or distances quoted are approximate and should not be used to value a property or be the basis of any sale or let.