



Day & Co
ESTATE AGENTS

28 Cavendish Street
Keighley
BD21 3RG



1-3 Cliff Street, Haworth,
Keighley, West Yorkshire, BD22
8JL

£168,000

T: 01535 664609

W: www.dayandcoestateagents.co.uk

E: keighley@dayandcoestateagents.co.uk

- End Terrace Property
- Accommodation over 3 Floors
- Front Paved Yard

- Two Bedrooms & Study
- Gas Central Heating & Double Glazing
- EPC Rating E

SUMMARY

** A SPACIOUS TWO BEDROOM PLUS STUDY DOUBLE FRONTED END TERRACE IN HAWORTH, WITH ACCOMMODATION OVER THREE FLOORS!!** Having gas central heating and double glazing, character features, sought after historic village location close to local schools and amenities, of interest to a variety of buyers - OFFERED FOR SALE WITH NO ONWARD CHAIN!! EPC RATING E

FULL DESCRIPTION

An internal viewing is advised to fully appreciate this spacious two bedroom & study, double fronted end terrace, situated in the popular village of Haworth. The accommodation briefly comprises of a lounge with stone flagged flooring, feature fireplace, window and door to the front. The kitchen with window and door to the front, range of base and wall mounted units, space for a small dining table, stone flagged flooring and gives access to a good size storage cellar. To the first floor there is a double bedroom, spacious house bathroom which has a suite comprising of corner bath, WC and was hand basin. Upper floor - there is a large open-plan landing/home study area which could be used as a walk-through bedroom. Door through to a double bedroom with a double glazed roof window and an en-suite wash room consisting of a W.C and sink basin. Gas central heating and double glazing. Outside this double fronted property has a paved area with surrounding walls. Space for outdoor seating to enjoy the views.

LOCATION The sought after historic village of Haworth provides a range of local amenities, such as shops, pubs, schools and bars.

NO ONWARD CHAIN. EPC Rating E

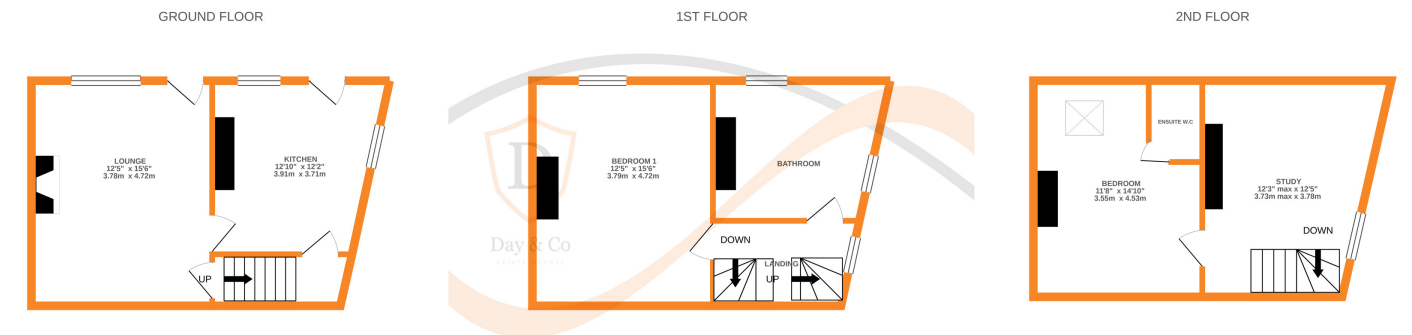

Whilst every attempt has been made to ensure the accuracy of the floorplan contained here, measurements of doors, windows, rooms and any other items are approximate and no responsibility is taken for any error, omission or mis-statement. This plan is for illustrative purposes only and should be used as such by any prospective purchaser. The services, systems and appliances shown have not been tested and no guarantee as to their operability or efficiency can be given.
Made with Metropix ©2021