



Longmead, Letchworth Garden City, Hertfordshire SG6 4HP
£550,000 Freehold

| Satchells





Step Inside

Offered to the market chain free, this bright and spacious extended detached bungalow provides well-proportioned accommodation throughout, thoughtfully arranged to maximise both light and practicality. A welcoming entrance hall sits at the centre of the home, giving access to all principal rooms and benefiting from useful built-in storage cupboards, ideal for coats, shoes and everyday household items. The living room is a generous and inviting space with ample room for both seating and dining furniture and enjoying an abundance of natural light. The kitchen is well sized and offers good worktop and cupboard space, creating a functional and bright environment for daily use; Its layout allows for easy movement and practical storage.

There are three genuine double bedrooms, all offering comfortable proportions. The main bedroom measures 3.89m x 3.47m (12'9" x 11'5") and easily accommodates a full range of bedroom furniture. Bedroom two is an impressively long and versatile room at 5.31m x 2.21m (17'5" x 7'3"), ideal as a bedroom, guest room or home office, while bedroom three measures 3.46m x 2.59m (11'4" x 8'6") and enjoys good natural light. The accommodation is completed by a well-positioned shower room fitted with a shower, WC and wash basin. Further storage is available throughout the property, complemented by the integral garage which provides excellent additional space for storage, hobbies or secure parking. Overall, the interior offers a light and airy feel with generous room sizes, good storage solutions and a practical layout, making this bungalow well suited to both comfortable everyday living and entertaining.

About Letchworth

Set into a prime location, Longmead offers a quiet, community-focused atmosphere while still being just minutes from the heart of Letchworth. Residents enjoy easy access to local amenities, including a variety of independent shops, cafes, and the popular Broadway cinema. The area is also well-served by supermarkets, leisure facilities, and highly regarded schools, making it an excellent choice for families and professionals alike. For commuters, Letchworth Garden City station is nearby, offering regular services into London King's Cross in under 40 minutes, while the A1(M) is just a short drive away for convenient road links north and south. Surrounded by leafy avenues, parks, and the signature open green spaces that define Letchworth, Longmead combines the best of town and country living, offering a peaceful retreat without sacrificing connectivity or convenience.





Step Outside

The property sits back from the road with an attractive frontage, featuring a low brick boundary wall, private driveway and an integral garage. The bungalow has a neat, well-proportioned appearance with a pitched roof, bay window and welcoming front entrance, all set within a quiet residential setting. To the rear is a generous, bright and sunny garden that is not overlooked, offering a high degree of privacy. Directly outside the property is a raised patio area, providing an ideal space for outdoor dining, relaxing or entertaining while enjoying views across the garden. Steps lead down from the patio to a well-maintained lawn, bordered by mature shrubs, fencing and established planting, creating a peaceful and secluded outdoor environment. Paved pathways run through the garden, offering practical access and defined areas, while a substantial greenhouse is positioned to one side, ideal for keen gardeners. A useful brick-built outbuilding provides additional storage or space for hobbies. Overall, the exterior combines privacy, sunshine and versatile outdoor spaces, making it perfect for both relaxation and practical use.



Ground Floor

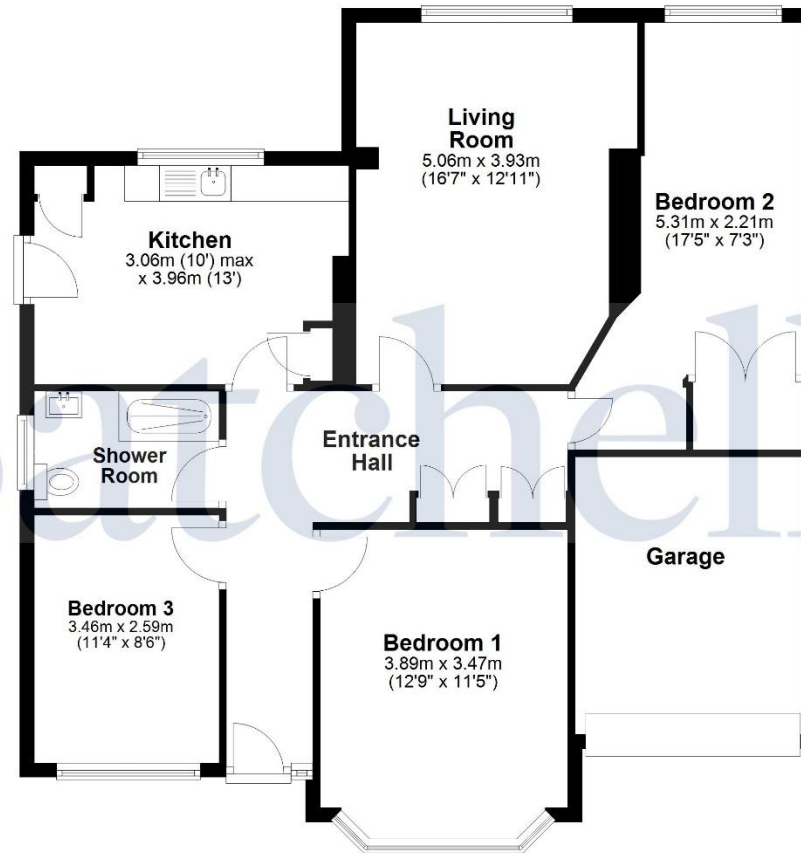

For illustration purposes only - NOT TO SCALE - Measurements shown are approximate. The size and position of doors, windows, appliances and other features are approximate.
Plan produced using PlanUp.

These particulars are a guide only and do not constitute an offer or a contract. The floorplan is for identification purposes only and not to scale. All measurements are approximate and should not be relied upon if ordering furniture, white goods and flooring etc. We have presented the property as we feel fairly describes it but before arranging a viewing or deciding to buy, should there be anything specific you would like to know about the property please enquire. Satchells have not tested any of the appliances or carried out any form of survey and advise you to carry out your own investigations on the state, condition, structure, services, title, tenure, and council tax band of the property. Some images may have been enhanced and the contents shown may not be included in the sale. Satchells routinely refer to 3rd party services for which we receive an income from their fee. If you would like us to refer you to one of these services, please ask one of our staff who will pass your details on. We advise you check the availability of the property on the day of your viewing.



Satchells



Station Place, Letchworth Garden City, Hertfordshire, SG6 3AQ.
01462 480077
letchworth@satchells.co.uk
www.satchells.com

| Satchells