

Green Lane, Shepperton, TW17 8DU

Guide Price £750,000



- Four Bedrooms
- Immaculate Condition Throughout
- Large Rear Garden
- Off Street Parking
- Modern Kitchen
- En-Suite to Master
- Close To Schools & Shops
- Two Outbuildings

Green Ln, Shepperton TW17 8DU

Approximate Gross Internal Area
Main House 1410 sq ft - 131 sq m
Outbuilding 140 sq ft - 13 sq m
Garage 161 sq ft - 15 sq m
Total 1711 sq ft - 159 sq m

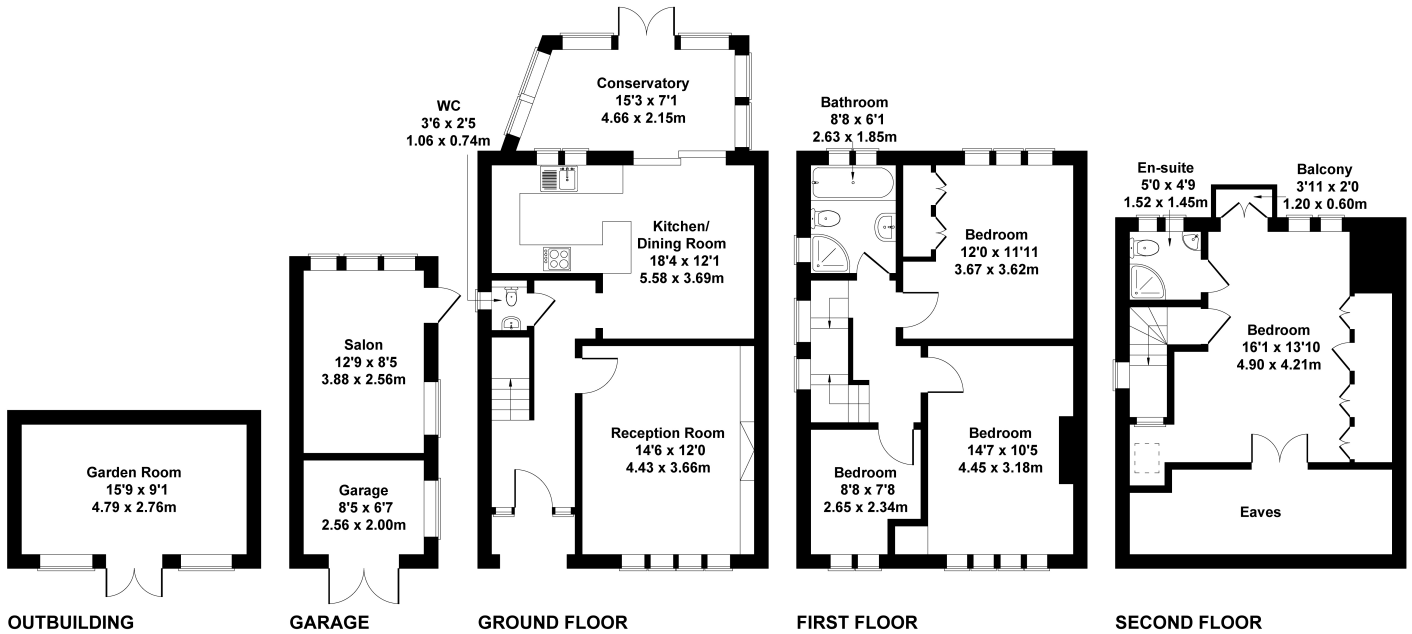

This floorplan is for guidance only and does not form part of an offer or contract.
Buyers or tenants should verify all details through inspection, searches, and surveys.
Measurements are approximate and should not be relied upon for valuation or transactions.
Produced by Plan Portal.
www.evolve.london.co.uk

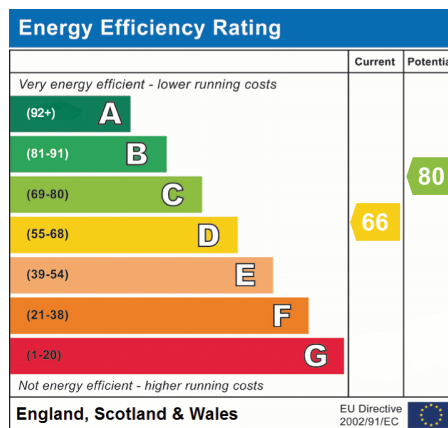

We have not tested the services or domestic appliances so we cannot verify that they are in working order. The buyer is advised to obtain verification from their solicitor or surveyor. These particulars form no part of any offer or contract and their accuracy cannot be guaranteed.