



Tel: 01242 676767

[www.cotswoldestateagents.co.uk](http://www.cotswoldestateagents.co.uk)

41a Church Road, Bishops Cleeve, Cheltenham, GL52 8LP

43 Rectory Court , Churchfields  
Bishops Cleeve GL52 8LJ

**£179,950**



FOR SALE



A unique opportunity to acquire this spacious first floor, two-bedroom apartment in the well regarded Rectory Court retirement development in the heart of the village, within easy walking distance of local shopping facilities and amenities as well as regular bus services to Cheltenham and the surrounding areas. The spacious living accommodation comprises entrance hall, lounge/diner, fitted kitchen, bathroom suite, two good sized bedrooms and built-in storage cupboards. The property further benefits from modern programmable thermostatic electric radiators. The excellent communal facilities including attractive communal gardens, guest suite, communal lounge and kitchens, lift, resident managers office and permit off-road parking. \*\* No onward chain \*\*











## First Floor

Approx. 61.6 sq. metres (663.0 sq. feet)

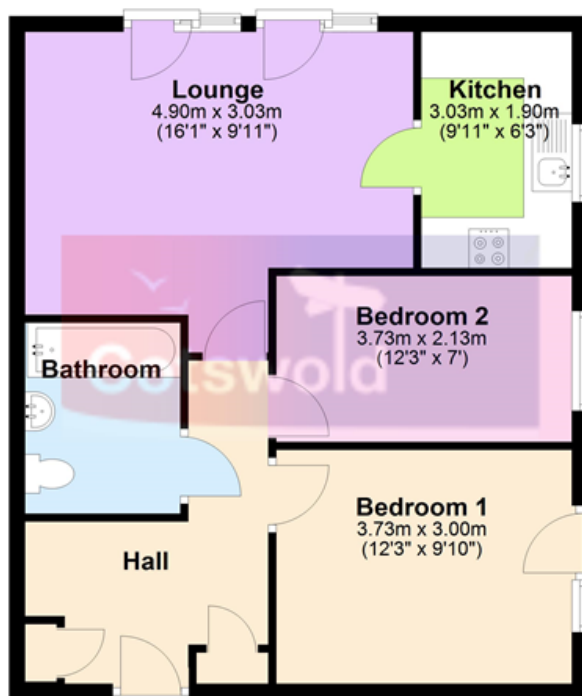

Total area: approx. 61.6 sq. metres (663.0 sq. feet)

Energy Efficiency Rating		
	Current	Potential
Very energy efficient - lower running costs		
(92+) <b>A</b>		
(81-91) <b>B</b>		
(69-80) <b>C</b>		77
(55-68) <b>D</b>	67	
(39-54) <b>E</b>		
(21-38) <b>F</b>		
(1-20) <b>G</b>		
Not energy efficient - higher running costs		
England, Scotland & Wales		
EU Directive 2002/91/EC		