

Rent
Me



Waters Edge, Warrington.

£795 pcm

Beautiful 2 Bedroom Apartment | Ground Floor | Views onto Ship Canal | Allocated Parking | Walking
Distance to Stockton Heath Village | Modern Fitted Kitchen | Available Now |



GROUND FLOOR
603 sq.ft. (56.0 sq.m.) approx.

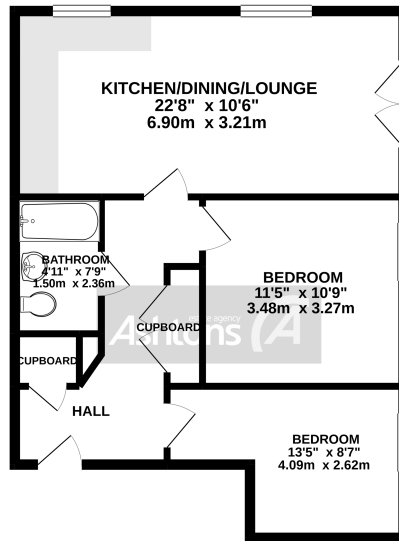

FROM ASHTONS LETTINGS

TOTAL FLOOR AREA: 603 sq.ft. (56.0 sq.m.) approx.

While every attempt has been made to ensure the accuracy of the floorplan, measurements, dimensions, areas, volumes and other data are approximate and should not be relied upon for any specific purpose. The services, systems and appliances shown have not been tested and no guarantee is made as to their operation or efficiency on the date made with Marketing CD02

This beautiful two bedroom ground floor apartment is located just a short stroll from Stockton Heath Village. The apartments position overlooks the Manchester Ship Canal via a Juliet Balcony. The modern fully fitted kitchen, lounge and dining area is open and is fitted with an integrated fridge, freezer, washer/dryer and dishwasher. The two bedrooms are both good sizes whilst the main bathroom is spacious. The hall has access to two separate storage cupboards. Also benefiting from allocated parking and telecom entry.



Contact your local office to arrange a viewing:

Padgate: 01925 479334
Great Sankey: 01925 454300
Winwick: 01925 232146
Stockton Heath: 01925 453400
St.Helens: 01744 754120
Wigan: 01942 498862
Culcheth: 01925 764744
Ashton-In-Makerfield: 01942 364446
Newton-Le-Willows: 01925 907770
Commercial Office: 01925 907709
Lettings Head Office: 01925 873533
Financial Services: 01925 221234

Viewing Arrangements

Viewing is strictly by appointment only through Ashtons Estate Agency.

Disclaimer Property Details

These particulars, whilst being believed to be accurate are set out as a general outline only for guidance and do not constitute any part of an offer or contract. Intending purchasers should not rely on them as statements of representation of fact, but must satisfy themselves by inspection or otherwise as to their accuracy. We have not carried out a detailed survey nor tested the services, appliances and specific furnishings. The measurements given are approximate.

No person in this firm's employment has the authority to make or give any representation or warranty in respect of the property.

All details, photographs and floorplans are the copyright of Ashtons Estate Agency.



How much you can borrow?
Speak to a mortgage expert in your local office.

Ashtons Financial Services

Ashtons.net rightmove

PrimeLocation.com Zoopla.co.uk

Ashtons