



27 Middle Road, Oakdale, Poole, Dorset BH15 3SH

£350,000 Freehold

info@anthonydavid.co.uk  
www.anthonydavid.co.uk  
01202 677444

A delightful three bedroom detached bungalow situated on this quiet residential road in Oakdale a short distance away from schools, shops, bus routes and amenities. This neat and tidy home offers versatile living space and viewing is essential to appreciate not only its location but also the accommodation on offer, which comprises: lounge, dining room, fitted kitchen and modern shower room. Externally there is a charming paved rear garden with raised beds and garden shed. To the front the driveway provides ample off road parking. Further features include: wall mounted feature fire to lounge, gas central heating and UPVC double glazing. Nearby Schools - Stanley Green Infants, Oakdale Juniors, Poole High and St Edwards RC/CoE Secondary.

**ANTHONY  
DAVID & CO**

GROUND FLOOR  
766 sq.ft. (71.2 sq.m.) approx.

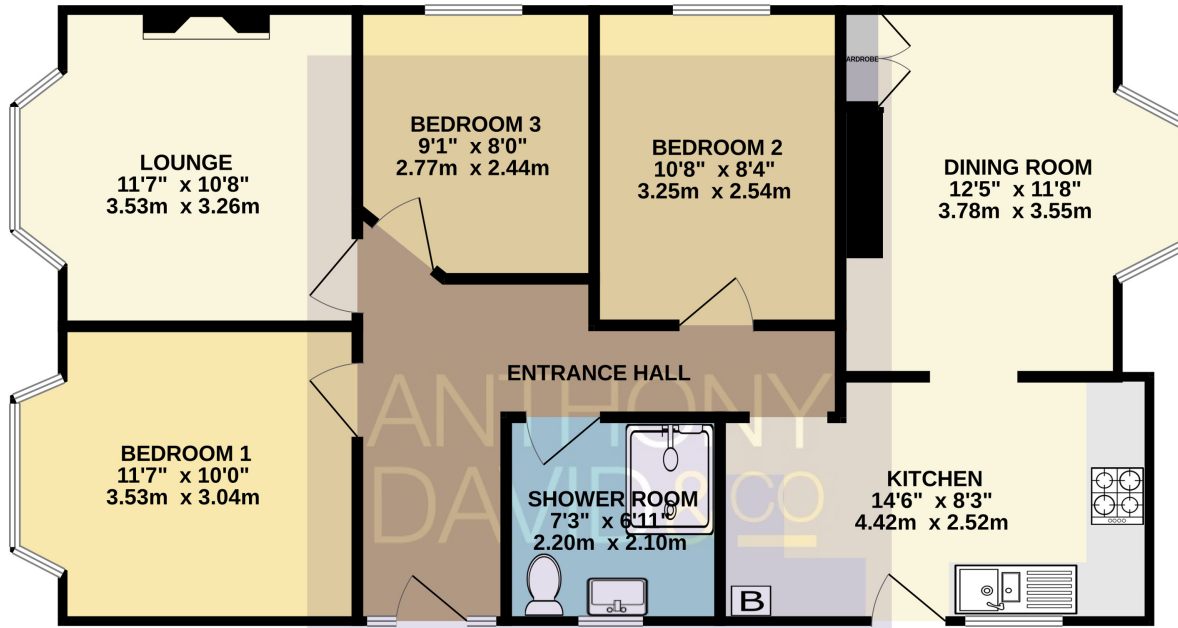

Entrance Hall Doors to

Lounge 11' 7" x 10' 8" (3.53m x 3.25m)

Kitchen 14' 6" x 8' 3" (4.42m x 2.51m)

Dining Room 12' 5" x 11' 8" (3.78m x 3.56m)

Bedroom One 11' 7" x 10' 0" (3.53m x 3.05m)

Bedroom Two 10' 8" x 8' 4" (3.25m x 2.54m)

Bedroom Three 9' 1" x 8' 0" (2.77m x 2.44m)

Shower Room 7' 3" x 6' 11" (2.21m x 2.11m)

Garden Low maintenance

Council Tax Band C

TOTAL FLOOR AREA: 766 sq.ft. (71.2 sq.m.) approx.

Whilst every attempt has been made to ensure the accuracy of the floorplan contained here, measurements of doors, windows, rooms and any other items are approximate and no responsibility is taken for any error, omission or mis-statement. This plan is for illustrative purposes only and should be used as such by any prospective purchaser. The services, systems and appliances shown have not been tested and no guarantee as to their operability or efficiency can be given.  
Made with Metropix ©2026

