

TO LET

£2,400 pcm

84 Greenway Gardens, Greenford, Greater London. UB6 9TX



Peter Gamble & Co are extremely pleased to offer to the market this NEWLY REDECORATED THREE BEDROOM HOUSE.

Comprising of a through lounge reception/dining room, kitchen, garden with detached GARAGE, two double bedrooms, one single bedroom and family bathroom. Newly redecorated and new carpet on the stairs,

Greenford Central Line station, multi bus routes with local shops in the area,



5 week deposit, Council Tax Band E, EPC Rating D.





# 84 Greenway Gardens

Key:

-  Smoke/Fire Alarm
-  Carbon Monoxide Detector
-  Gas Boiler

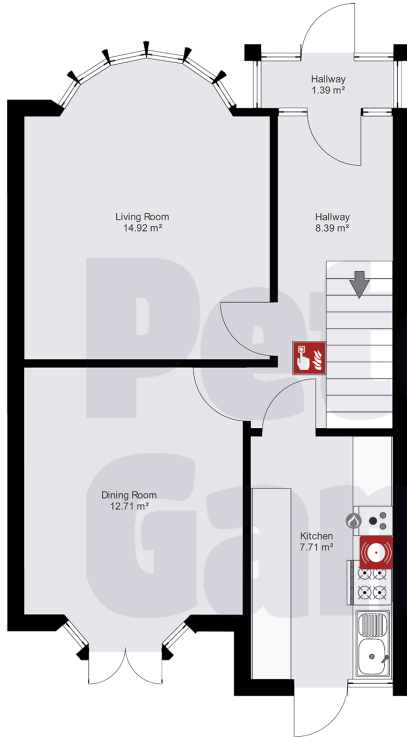

Ground Floor

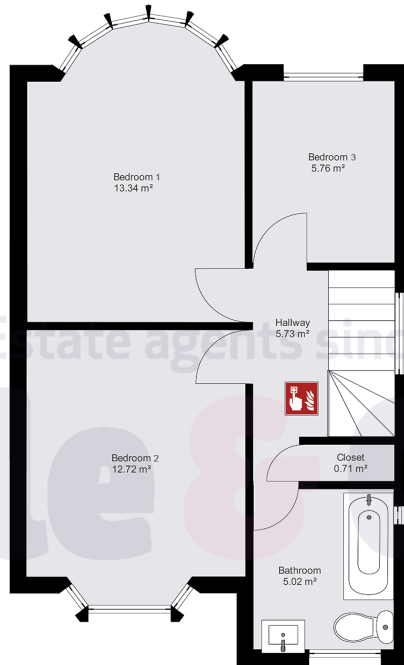

First Floor

APPROX. GROSS INTERNAL FLOOR AREA: 92.2 sq. m

WHILST EVERY ATTEMPT HAS BEEN MADE TO ENSURE THE ACCURACY OF THE FLOOR PLAN CONTAINED HERE, NO RESPONSIBILITY IS TAKEN FOR ANY ERROR, OMISSION OR MIS-STATEMENT. THIS PLAN IS FOR ILLUSTRATIVE PURPOSES ONLY AND SHOULD BE USED AS SUCH

© Avasmo Energy

Energy Efficiency Rating		
	Current	Potential
Very energy efficient - lower running costs		
(92+) <b>A</b>		
(81-91) <b>B</b>		86
(69-80) <b>C</b>		
(55-68) <b>D</b>	63	
(39-54) <b>E</b>		
(21-38) <b>F</b>		
(1-20) <b>G</b>		
Not energy efficient - higher running costs		
England, Scotland & Wales	EU Directive 2002/91/EC	