



109 High Avenue, Letchworth Garden City, Hertfordshire, SG6 3QW

£240,000

Lane & Bennetts are delighted to bring to market this well maintained, two double bedroom maisonette. There is a dual aspect, open plan lounge / dining area, a fitted kitchen with appliances and family bathroom.

There is good storage within the home, lovely communal areas and is well located, just a 12 minute walk to town, a 15 minute walk to the station and 5 just minutes to the Letchworth Greenway.

This home has sought after schools within an easy walk (5 minutes). Leisure & sports interests are also well catered for as within a mile you can choose between Letchworth Garden City's renowned golf club, Letchworth Tennis club, the Letchworth Cricket & Hockey clubs and Nuffield Health gym & spa.



109 High Avenue

Approximate Gross Internal Area
689 sq ft - 64 sq m

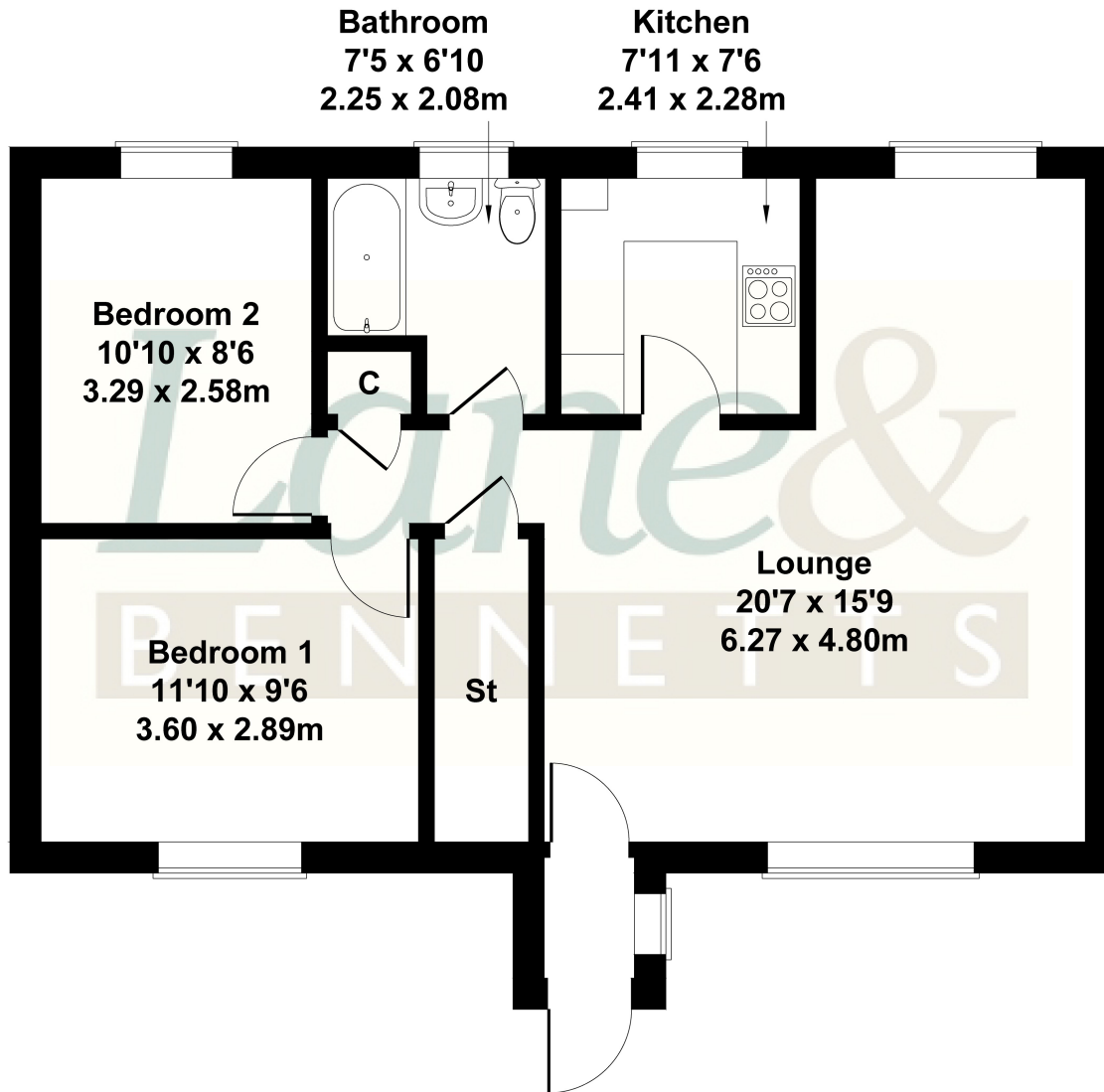

- TWO DOUBLE BEDROOMS
- GROUND FLOOR MAISONETTE
- FITTED KITCHEN & APPLIANCES
- GARAGE
- OPEN PLAN DUAL ASPECT LOUNGE / DINING AREA
- BATHROOM WITH SHOWER OVER
- ENTRANCE PORCH
- COMMUNAL GROUNDS
- 12 MINUTES WALK TO TOWN
- JUST MINUTES TO THE LETCHWORTH GREENWAY



Not to Scale. Produced by The Plan Portal 2023
For Illustrative Purposes Only.