



## 20 Hillcroft Green, Douglas, Isle of Man. IM2 7ES

Superb end terraced home with modern kitchen/diner and open aspect to front.

Open House - Monday 19th August 12-2PM



**£299,950 Freehold**



## PROPERTY DESCRIPTION

---

Open House - Monday 19th August 12-2PM

Welcome to 20 Hillcroft Green. This superb property has been tastefully modernised over the past few years and is situated within the heart of the ever popular Governors Hill.

Hillcroft Green offers convenient access to Cronk Y Berry Primary School, Bemahague Secondary School, Hailwood Medical Centre, The Cat with No Tail and plenty more. An ideal location for couples and families alike. The property faces a large open green area to front which makes for a more private feel.

On entering the property, turn right and you are greeted with a large front facing lounge with media wall, under stairs storage and open aspect. The property then further opens into a well fitted open plan kitchen/diner with French doors leading to the South East facing garden. The kitchen is fitted with modern, white, wall and base units with butchers block worktops above.

Upstairs you will find three bedrooms and a modern bathroom, the master bedroom benefits from fitted wardrobes and the same aspect as the lounge.

Stepping outside, there is a generous lawned garden which faces South East with gated access to the side and space for a shed.

## FEATURES

---

- Open House Monday 19th August 12-2PM
- Modern End Terraced Home
- Desirable Residential Location
- Open Aspect to Front
- Large Lounge plus Modern Kitchen/Diner
- 3 Bedrooms plus Bathroom
- Generous Lawned Garden to Rear



# Property Images



# FLOORPLAN

GROUND FLOOR  
408 sq.ft. (37.9 sq.m.) approx.

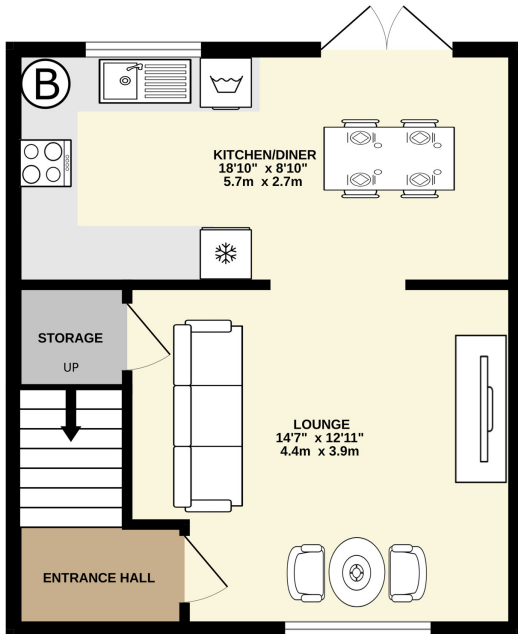

1ST FLOOR  
383 sq.ft. (35.6 sq.m.) approx.

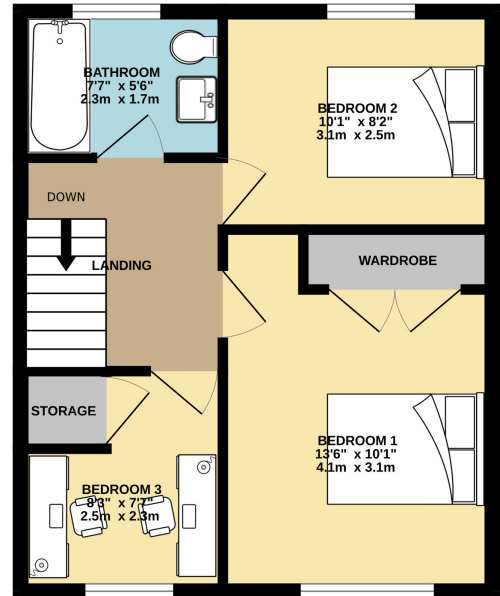

TOTAL FLOOR AREA : 791 sq.ft. (73.5 sq.m.) approx.

Whilst every attempt has been made to ensure the accuracy of the floorplan contained here, measurements of doors, windows, rooms and any other items are approximate and no responsibility is taken for any error, omission or mis-statement. This plan is for illustrative purposes only and should be used as such by any prospective purchaser. The services, systems and appliances shown have not been tested and no guarantee as to their operability or efficiency can be given.  
Made with Metropix ©2024

**DISCLAIMER:** Whilst Manxmove Ltd believe that these details are correct, neither Manxmove Ltd or their clients guarantee their accuracy in any way. Consequently, these details are not to be used to form part of any legally binding contract. Prospective purchasers or tenants are advised to visit this property to satisfy themselves as to the correctness of these details. Please note, we use wide angle camera lenses in order to show as much of each room as possible. This is not intended to mislead any prospective purchasers or tenants in any way and an honest verbal description is always available prior to viewing if required.