

FOR SALE

£275,000

Westbourne Grove, West Kirby, Wirral. CH48 4DJ



Spacious Garden Apartment with No Chain!! Situated in a highly sought after part of West Kirby, on the flat, with all of local shops, amenities, attractions and transport links within minutes this delightful ground floor garden apartment has huge appeal for many potential buyers. The generous accommodation (circa 950sqft) is currently configured as a one double bedroom apartment but offers more space overall than many two bedrooms options in the local area. We're confident that with well considered plans and alterations the space could be reconfigured to create two bedrooms.

Rarely do apartments in this area come with the added benefits of both off road parking and private gardens (certainly not of the scale of this particular example). With self contained access to the rear, the property enjoys a generous paved patio, an extensive lawned garden, as well as established borders of





Ground Floor

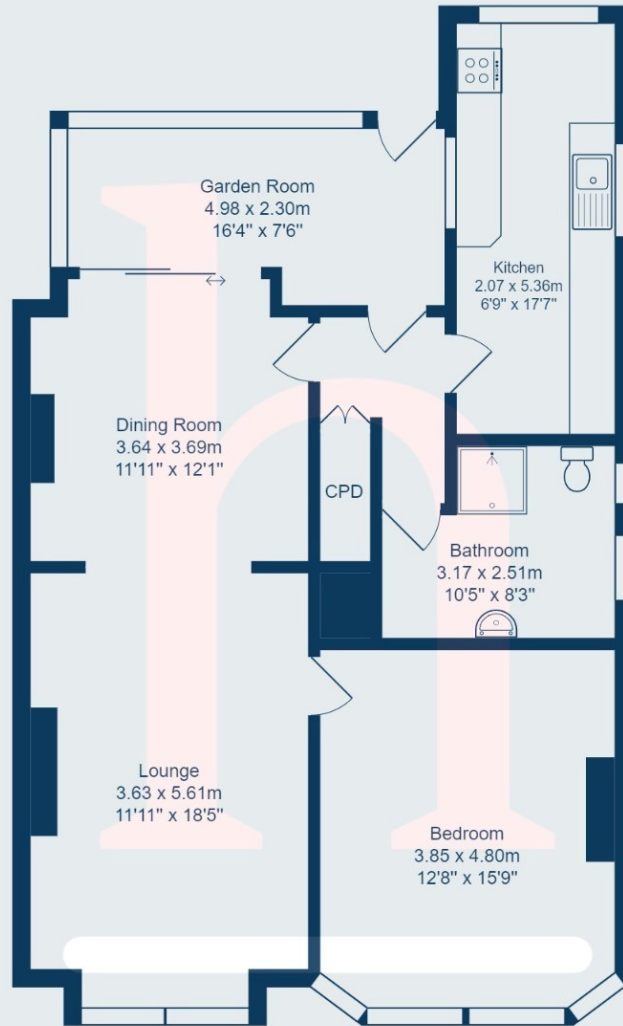

Total Area: 88.3 m² ... 950 ft²

All measurements are approximate and for display purposes only.