



Pontardulais Road  
Gorseinon  
Swansea  
West Glamorgan  
SA4 4FF

Offers in Excess of £234,000

bettermove 



# Pontardulais Road Swansea

Bettermove are proud to present this 3 bedroom semi-detached house in Gorseinon available with no forward chain.

The property benefits from double glazing, gas central heating throughout and has off street parking available via the driveway. The council tax band is D.

The interior of this beautifully presented property comprises a spacious living room, open plan dining room and fitted kitchen on the ground floor. The first floor consists of 3 bedrooms and the family bathroom. The exterior boasts a larger than average enclosed rear garden with mature fruit trees, perfect for enjoying the summer months.

Located in the popular town of Gorseinon, ideally located within walking distance of school and all the amenities of Gorseinon town. Excellent transport connections can be found from the M4 and many local buses providing easy access into Swansea City Centre.

This exciting opportunity should not be missed! All enquiries can be made through Bettermove on 0330 004 0050.

You can secure the purchase today by paying an exclusivity fee of £1,000 which gives you the rights to purchase within a given timeframe.

Paying this fee ensures that the seller takes their property off the market and reserves it exclusively for you, therefore eliminating the risk of gazumping and aborted costs.

The exclusivity fee is returned to you upon successful completion of the property.



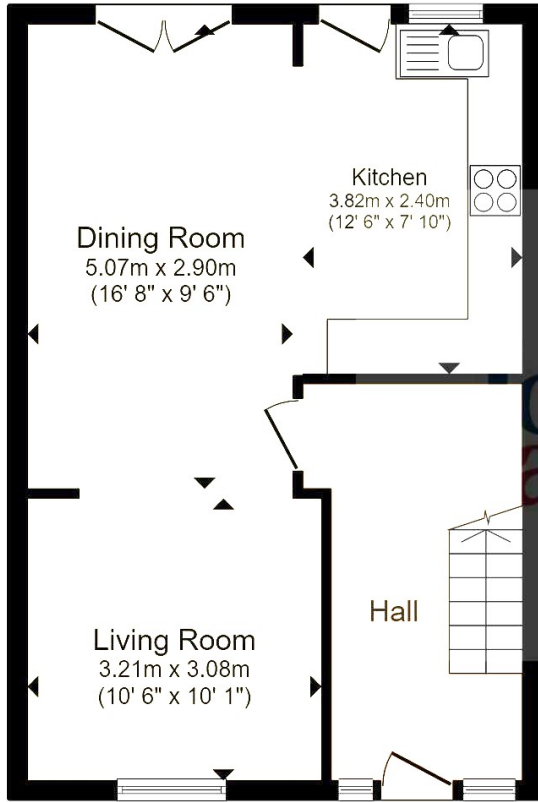

**Ground Floor**

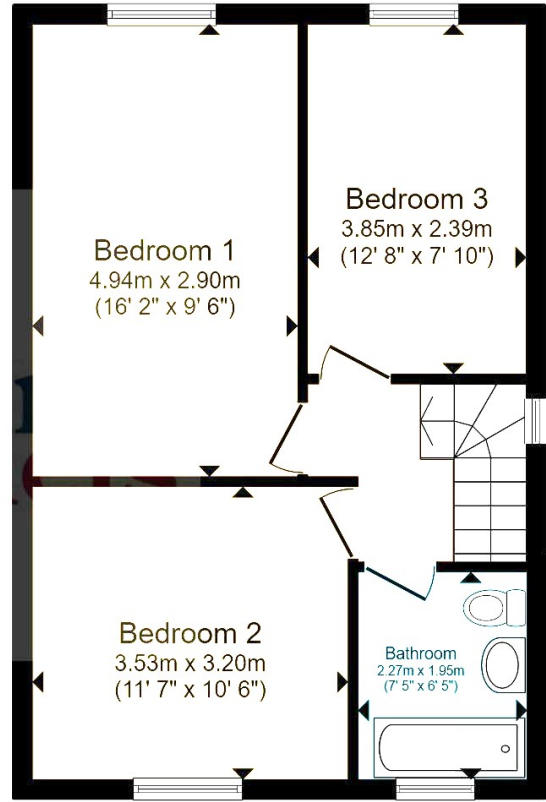

**First Floor**

Total floor area 89.0 sq.m. (958 sq.ft.) approx

This floorplan is for illustrative purposes only and is not drawn to scale. Measurements, floor-areas, openings and orientations are approximate. They should not be relied upon for any purpose and do not form any part of an agreement. No liability is taken for any error or mis-statement. All parties must rely on their own inspections.

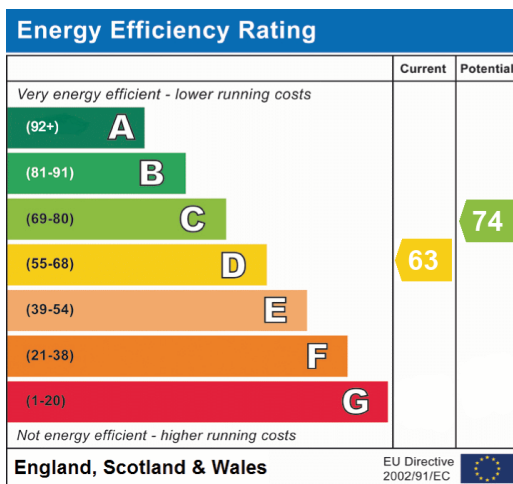





20-22 Bridge End, Leeds, LS1 4DJ  
t: 0330 004 0050 e: hello@bettermove.co.uk  
[www.bettermove.co.uk](http://www.bettermove.co.uk)