

Truuli



Jamaica Road, Thornton Heath, Surrey, CR7 7HD

£375,000 Share of Freehold

- Share of freehold flat
- Private rear section of the garden
- Close to Croydon University Hospital
- Split level accommodation
- Ready to move in
- No onward chain

2, Lansdowne Road, Croydon, Surrey, CR9 2ER

Tel: 0330 043 0002

Email: save@truuli.co.uk Web: www.truuli.co.uk

Jamaica Road, Thornton Heath, Surrey, CR7 7HD

£375,000 Share of Freehold

This is a great opportunity to acquire this light and airy, well- proportioned three-bedroom shared freehold flat on Jamaica Road.

Ground Floor Entrance
25 sq ft (2.3 sq m) approx.

First Floor
329 sq ft (30.3 sq m) approx.

2nd Floor
286 sq ft (26.5 sq m) approx.

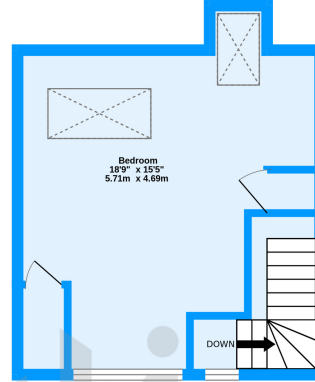
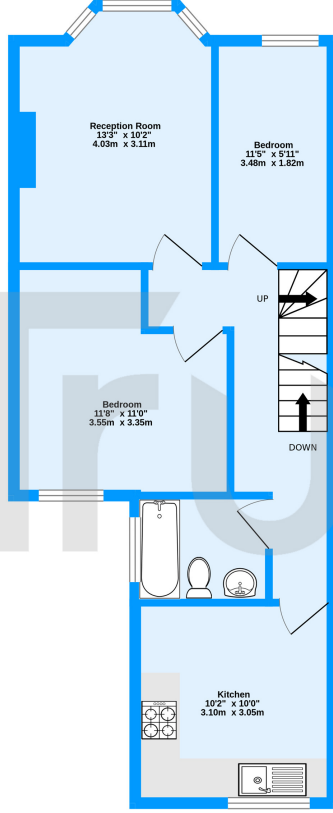
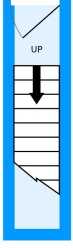

Jamaica Road, Thornton Heath, CR7

TOTAL FLOOR AREA : 829 sq ft. (77.0 sq.m.) approx.
Measurements are approximate. Not to scale. Illustrative purposes only
Made with Metropix ©2023

Energy Efficiency Rating		Current	Potential
Very energy efficient - lower running costs			
(92+)	A		
(81-91)	B		
(69-80)	C		
(55-68)	D	60	73
(39-54)	E		
(21-38)	F		
(1-20)	G		
Not energy efficient - higher running costs			
England, Scotland & Wales		EU Directive 2002/91/EC	

