



9 Whittle Court,  
Knowlhill, Milton Keynes, MK5 8FT

Tel: 01908 231 551  
mail@elevationstateagents.com



elevation  
lettings est. 1992

**Flat 17, 202 Granton House Silbury  
Boulevard, Milton Keynes,  
Buckinghamshire, MK9 1FJ**

**£215,000 Leasehold**

- 1-Bedroom modern apartment
- Ideal for busy professionals
- Fully fitted bespoke kitchen with granite work tops
- Integrated 'Smeg' Appliances
- Video entry systems
- 0.35 Miles from Milton Keynes Train Station
- Lift access to all apartments
- EPC Rating

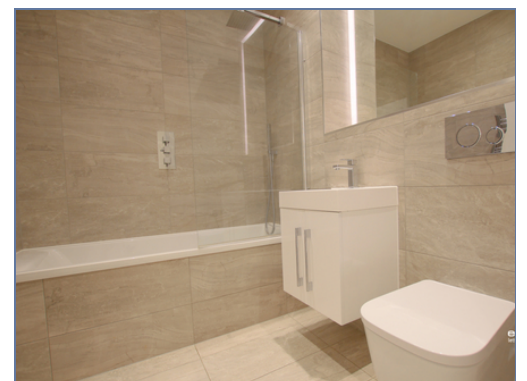

See our full selection of properties online at [www.elevationstateagents.com](http://www.elevationstateagents.com)



Stylish open plan lounge/kitchen/diner, a double bedroom with GREAT space for storage and a family bathroom. Specification is of a high standard including fully integrated kitchen, granite work tops with Smeg appliances, quality flooring throughout, USB plug points, fully tiled bathroom and video entry systems. All floors have got access via stairs and lift. Located on the first floor with natural light due to the open plan living.

This Prestigious Building is located in a prime location in Central Milton Keynes, only 0.35 miles from Milton Keynes Train Station, walking distance to a numerous amount of restaurants and bars and close to centre:mk Shopping Centre with parking at Intu Milton Keynes.

£2000 - Service Charge

£250 - Ground Rent

## Bedroom

3.17m x 3.81m (10' 5" x 12' 6")

## Bathroom

1.89m x 2.37m (6' 2" x 7' 9")

## Living / Dining / Kitchen

4.02m x 5.02m (13' 2" x 16' 6")

## Disclaimer

Whilst we have endeavoured to prepare our sales particulars accurately none of the services, appliances or equipment have been tested. A buyer should satisfy themselves on such matters prior to purchase. Any measurements or distances mentioned in these particulars are for guide reference only. If such particulars are fundamental to a purchase, buyers should rely on their own enquiries. All enquiries should be directed to Elevation Estate Agents in the first instance.

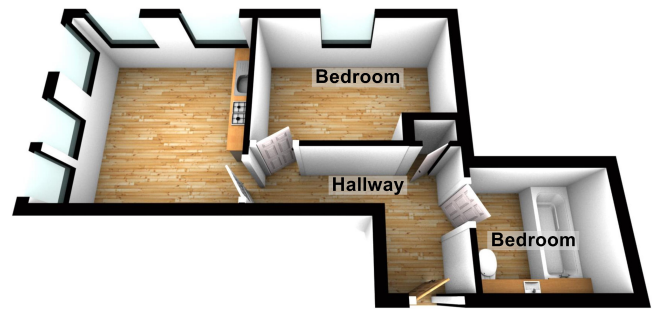

Floor plans are for layout purposes only  
Plan produced using PlanUp.