



<https://www.burnapandabel.co.>

Bedroom Two

14' " x 7' 11" (NaNm x 2.41m)

Bedroom Three

10' 4" x 8' 3" (3.15m x 2.51m)

Shower Room

Lounge/Dining Room

16' 6" x 14' 0" (5.03m x 4.27m)

Kitchen

11' 3" x 7' 0" (3.43m x 2.13m)

Bedroom One

14' 8" x 14' 1" (4.47m x 4.29m)

Bathroom

8' 11" x 5' 7" (2.72m x 1.70m)

Garden

Off Street Parking

Off Street Parking For Two Cars

Area Information

Located in an ideal position and easy reach of the centre of Dover and newly opened St James' Retail Park, the nearby mainline railway station provides quick access to London St Pancras International via HS1 and lines connecting to Kent towns. There is a nearby shop a short walk away and several primary and secondary schools are dotted around the town. The Port and iconic White Cliffs are a short drive as is the medieval castle.

Lower Ground Floor
Approx. 30.7 sq. metres (330.4 sq. feet)

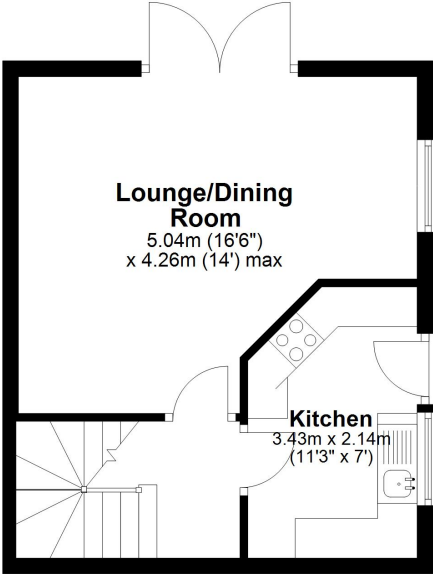

Ground Floor
Approx. 30.7 sq. metres (330.4 sq. feet)

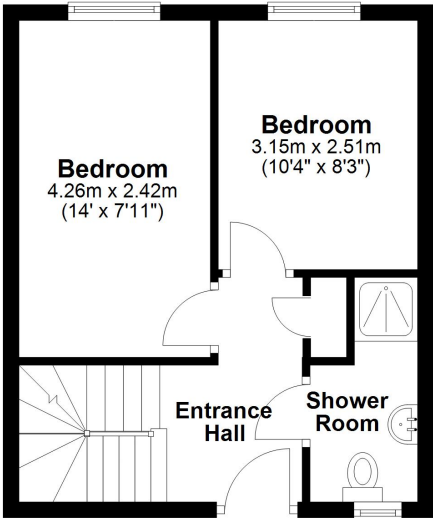

First Floor
Approx. 28.4 sq. metres (306.0 sq. feet)

