



- Three Bedroom Bungalow
- Private Road Consisting Of Just 4 Properties
- Fully Detached
- Garage & Ample Off Road Parking
- No Onward Chain
- 20' Kitchen/Diner
- Bespoke Fitted Window Shutters
- Sought After Village Location
- Easy Reach Of The Kelvedon Train Station
- Low Maintenance Rear Garden

### Glen Almond, The Street, Feering, Colchester, Essex. CO5 9QQ.

Occupying an enviable position at the end of private road within the sought after village of Feering, Michaels Property Consultants are delighted to present to the market this well established three bedroom detached bungalow. New to the market and offered for sale with no onward chain, this superb property also boasts picturesque views of the All Saints church which dates back over 850 years, as well being located within easy reach of both a village pub and the Kelvedon railway station.



# Property Details.

## Internal Accommodation

### Entrance Hall

### Living Room



16' 5" x 11' 4" (5.00m x 3.45m)

### Kitchen/Diner



20' 2" x 8' 9" (6.15m x 2.67m)

### Bedroom One



12' 4" x 9' 9" (3.76m x 2.97m)

# Property Details.

## Bedroom Two



10' 4" x 8' 1" (3.15m x 2.46m)

## Bedroom Three

8' 0" x 6' 5" (2.44m x 1.96m)

## Refitted Family Shower Room



## Outside

### Landscaped Rear Garden With Raised Decking Area



### Garage & Driveway

### Two Additional Parking Spaces To The Front



# Property Details.

## Floorplans

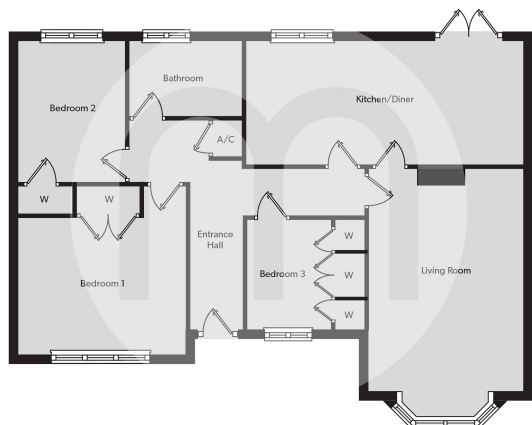

## Location

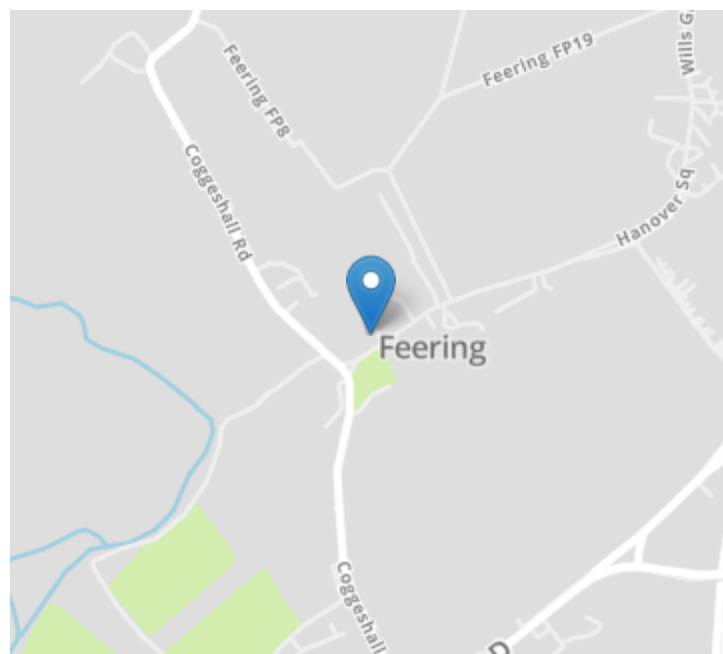

## Energy Ratings

We have not carried out a structural survey and the services, appliances and specific fittings have not been tested. All photographs, measurements, floor plans and distances referred to are given as a guide only and should not be relied upon for the purchase of carpets or any other fixtures or fittings. Gardens, roof terraces, balconies and communal gardens as well as tenure and lease details cannot have their accuracy guaranteed for intending purchasers. Lease details, service ground rent (where applicable) are given as a guide only and should be checked and confirmed by your solicitor prior to exchange of contracts.