



Day & Co  
ESTATE AGENTS

28 Cavendish Street  
Keighley  
BD21 3RG



38 Woodlands Rise, Haworth,  
Keighley, West Yorkshire, BD22  
8AJ

£149,950

T: 01535 664609

W: [www.dayandcoestateagents.co.uk](http://www.dayandcoestateagents.co.uk)

E: [keighley@dayandcoestateagents.co.uk](mailto:keighley@dayandcoestateagents.co.uk)

- EPC Rating Is C
- Three Bedrooms
- Generous Size Rear Garden

- Semi-Detached Property
- Drive & Garage
- Sought After Historic Village Location Of Haworth/Excellent Access To Village Amenities & Attractions

## SUMMARY

**\*\*A 3 BEDROOM SEMI-DETACHED PROPERTY, SOUGHT AFTER HISTORIC VILLAGE OF HAWORTH WITH EXCELLENT ACCESS TO VILLAGE AMENITIES, ATTRACTIONS AND THE LOCAL PRIMARY SCHOOL!\*\*** Having a drive, garage, generous size rear garden, open outlook to the front - OF INTEREST TO A VARIETY OF BUYERS!! EPC rating is C.

## FULL DESCRIPTION

Of interest to a variety of buyers is this three bedroom semi-detached property situated in the sought after historic village of Haworth with excellent access to village amenities, attractions and the primary school. The family size accommodation comprises of an entrance hall, the lounge has double glazed window to the front and radiator. The kitchen measures approximately 17ft in length and has a range of base and wall mounted units, integrated double oven, hob, dishwasher, two double glazed windows to the rear. There is a separate utility room with double glazed doors to both front and rear and plumbing for an automatic washing machine. To the first floor there are three bedrooms, and the bathroom which has a three piece suite comprising of a bath with shower over, WC, wash hand basin, two double glazed windows to the rear. Externally the property has a drive, garage, generous size rear garden. Open outlook to the front, EPC rating is C.

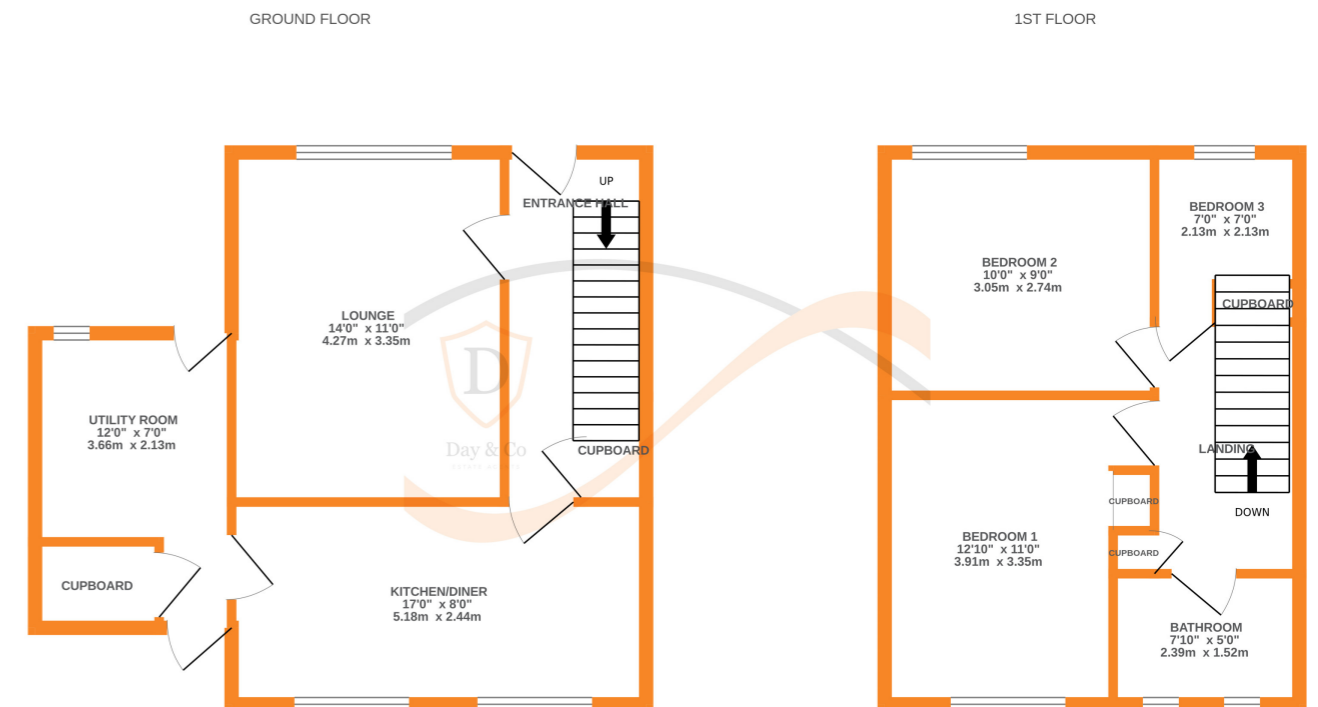

Whilst every attempt has been made to ensure the accuracy of the floorplan contained here, measurements of doors, windows, rooms and any other items are approximate and no responsibility is taken for any error, omission or mis-statement. This plan is for illustrative purposes only and should be used as such by any prospective purchaser. The services, systems and appliances shown have not been tested and no guarantee as to their operability or efficiency can be given.  
Made with Metropix ©2023