



High Street,  
Goldenhill



**OneAgency**

01782 970222

[hello@oneagencygroup.co.uk](mailto:hello@oneagencygroup.co.uk)





# Offers in Excess of £85,000

**\*ATTENTION INVESTORS\*** A two bedroom end townhouse in a popular location. The property is being sold tenanted achieving an income of £6180 per annum. Ideal for investment as a buy to let property. Call for further information or a viewing.





## Ground Floor

### Lounge

4.14m x 3.93m (13' 7" x 12' 11") A double glazed window to the front, fireplace and surround, storage cupboard, radiator and laminate flooring.

### Kitchen

4.95m x 2.81m (16' 3" x 9' 3") A range of base units with worktops, stainless steel sink basin, oven with gas hobs, plumbing for a washing machine, radiator, double glazed window, side door and tiled flooring.

## First Floor

### Bedroom One

4.98m x 3.97m (16' 4" x 13' 0") Two double glazed windows to the front, radiator and carpet flooring.

### Bedroom Two

3.80m x 2.75m (12' 6" x 9' 0") A double glazed window to the rear, radiator and carpet flooring.

### Bathroom

2.79m x 2.10m (9' 2" x 6' 11") A white suite with bath, pedestal hand wash basin, low level w/c, tiled walls, double glazed window to the rear and tiled flooring.

### External

Front - Paved steps leading to the front door, lawned section.

Rear - Paved area with lawned section and fenced borders.

GROUND FLOOR

1ST FLOOR

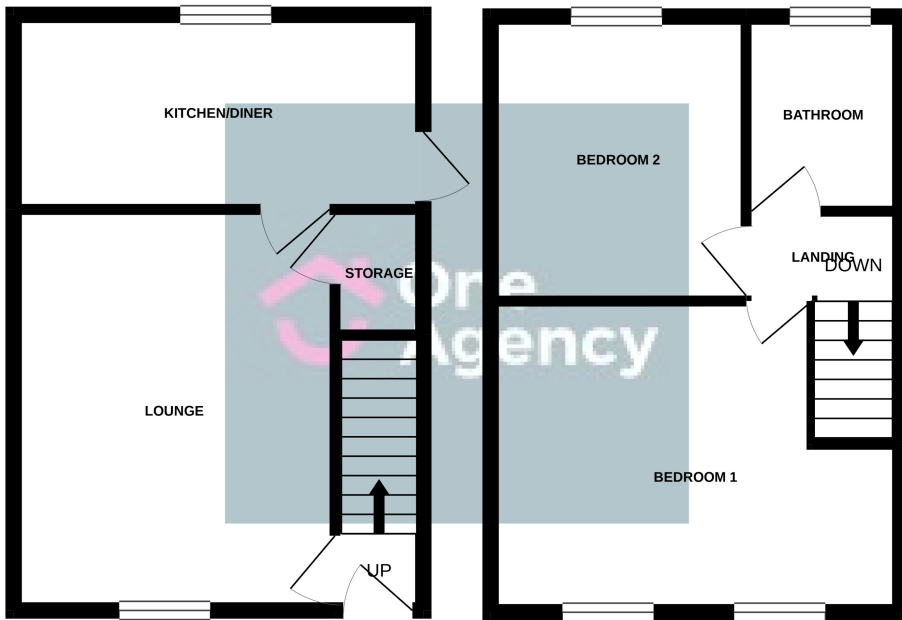

Whilst every attempt has been made to ensure the accuracy of the floorplan contained here, measurements of doors, windows, rooms and any other items are approximate and no responsibility is taken for any error, omission or mis-statement. This plan is for illustrative purposes only and should be used as such by any prospective purchaser. The services, systems and appliances shown have not been tested and no guarantee as to their operability or efficiency can be given.  
Made with Metropix ©2021

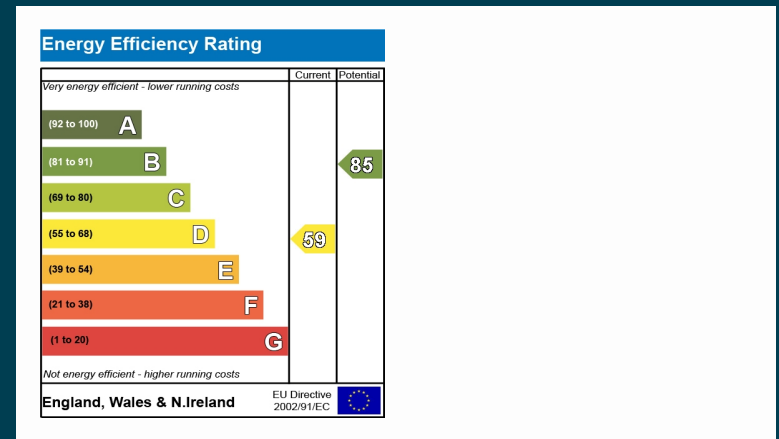

OneAgency, 9 & 10 Ridge House Drive, Festival Park, Stoke-on-Trent, ST1 5SJ

01782 970222

hello@oneagencygroup.co.uk

Every attempt has been made to ensure accuracy, however, all measurements are approximate and for illustrative purposes only. **Not to scale.**

In accordance with The Consumer Protection from Unfair Trading Regulations 2008 the following particulars have been prepared in good faith and they are not intended to constitute part of an offer or contract. We have not carried out a structural survey and the services, appliances and specific fittings have not been tested. All photographs, measurements, floor plans and distances referred to are given as a guide only and should not be relied upon for the purchase of carpets or any other fixtures and fittings. Lease details, service charges and ground rent (where applicable) are given as a guide only and should be checked and confirmed by your Solicitor prior to exchange of contracts.