

Truuli



Campion Close, Croydon, Surrey, CR0 5SN

£350,000 Leasehold

- South facing balcony
- Two double bedrooms
- Two bathrooms
- Ground floor
- Allocated parking space
- Built in storage in both bedrooms
- Garage available

Southbridge Place, Surrey, CR0 4HA

Tel: 0330 043 0002

Email: save@truuli.co.uk Web: www.truuli.co.uk

Campion Close, Croydon, Surrey, CR0 5SN

£350,000 Leasehold

Set within one of South Croydon's most popular developments, Campion Close, this spacious two-bedroom, two-bathroom apartment is offered to the mark with no onward chain. Campion Close is located off of Coombe Road, allowing you to be within close proximity of South Croydon Rail Station, Coombe Road Tram Stop, & Lloyd Park.

Ground Floor
751 sq.ft. (69.8 sq.m.) approx.

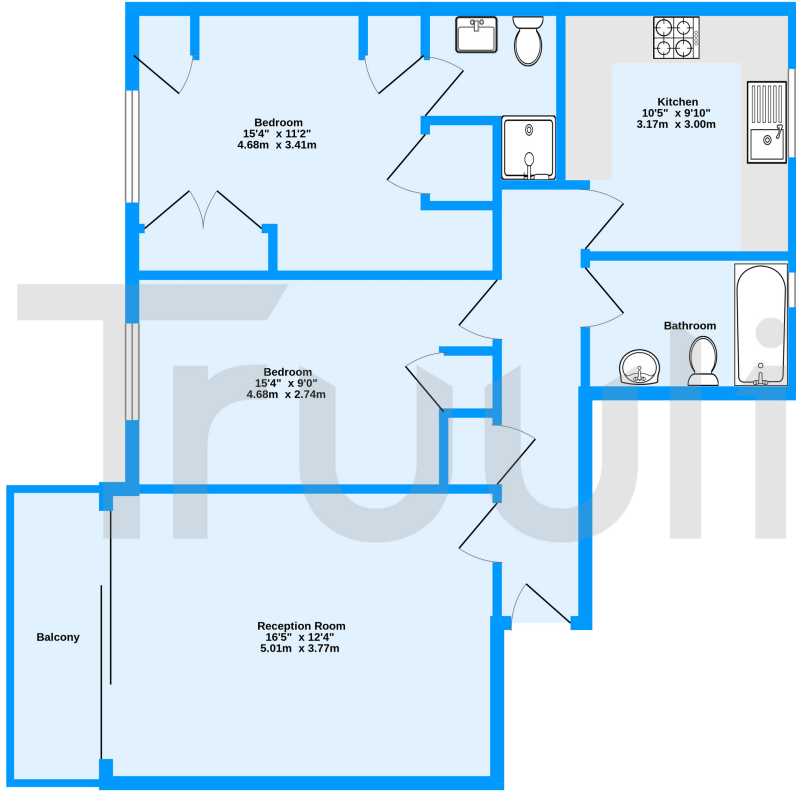

Campion Close, CRoydon, CR0
TOTAL FLOOR AREA: 751 sq.ft. (69.8 sq.m.) approx.
Measurements are approximate. Not to scale. Illustrative purposes only
Made with Metropix ©2024

Energy Efficiency Rating		Current	Potential
Very energy efficient - lower running costs			
(92+)	A		
(81-91)	B		
(69-80)	C	80	80
(55-68)	D		
(39-54)	E		
(21-38)	F		
(1-20)	G		
Not energy efficient - higher running costs			
England, Scotland & Wales		EU Directive 2002/91/EC	

